

# Olympia Triumph Manufacturing Limited

Olympia Triumph Manufacturing Limited – 15 Westminster Road – Wareham – Dorset – BH20 4SP

Email: [sales@olytri.com](mailto:sales@olytri.com) – Website: [www.olytri.com](http://www.olytri.com)

Tel. 01929.555350 – Fax. 01929.550894

---



## **Olympia Triumph Manufacturing Limited**

### **Fittings Catalogue**

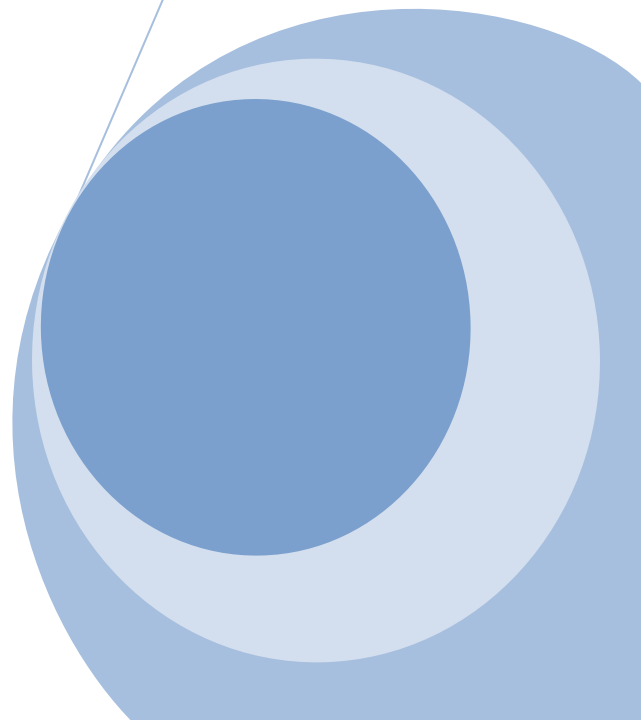

## Important Information

### 1. Pictures:

Pictures shown are not to scale. Please note table of dimensions.

### 2. Technical Data / Mechanical Tests:

All dimensions and weights stated especially the working loads and breaking strengths are approximate values and are quoted without warranty. Technical alterations reserved.

### 3. Finishes:

All products are supplied in standard finishes relevant information is indicated against each article. Other finishes upon request.

### 4. Load values:

The mentioned working and breaking strengths are average values out of a range and therefore you cannot refer this to each piece.

**Working load =** maximum load permitted given without warranty.

**Breaking strength without warranty =**

- a) Average values calculated by random sampling under conditions close to their application where parts break or deform, thus becoming improper for any further use.
- b) When safety is required because loads have to be handled or a man or a Portion of the weight of a man has to be supported, appropriate products with certified breaking strength are to be used. Approval should be sought from our qualified technical department regarding the selection and suitability of appropriate Fittings, from time to time our approval should be sought regarding selection and suitability of appropriate fittings. All mentioned breaking strengths are only guide numbers and absolutely no guarantee features as defined by § 459,2 BGB.

Articles with determined breaking strengths available in: - Product Group 5  
KAMET fittings for safety harnesses (personal protection equipment).

Product Group 6 KAMET fittings for Cargo restraint systems

All other articles undergo a random sampling check. There is no check piece by piece. Changes of the article description referring the origin are in the responsibility of our company.

### 5. Prices:

For the effective prices and terms of deliveries please see our actual price list.



Rope & Chain

Safety

Tex

Tex Parts

# Snap Hook



50



50-6



50-L



51



52

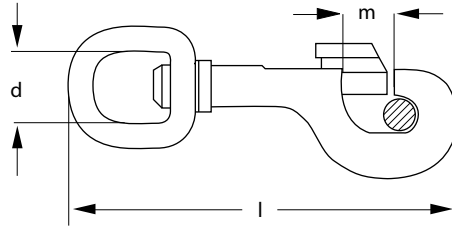

Name	Ident. no.	sur	Material		d		l mm	m mm	pack. unit	kg per 100 pcs	EAN-no. 4012053
			Body	Spring	inch	mm					
50-13	929929	vn	ZD	NS	1/2	13,0	72,0	8,0	50	3,4	09180 1
50-16	929930	vn	ZD	NS	5/8	16,0	77,0	8,0	50	3,5	09181 8
50-19	929931	vn	ZD	NS	3/4	20,0	81,0	8,0	50	3,6	09182 5
50-22	931181	vn	ZD	NS	7/8	22,0	83,0	8,0	50	3,8	09183 2
50-25	931182	vn	ZD	NS	1	26,0	86,0	8,0	50	3,9	09184 9
50-6-16	931184	vn	ZD	NS	5/8	16,0	70,0	8,0	50	3,6	09185 6
50-6-19	931185	vn	ZD	NS	3/4	19,0	75,0	8,0	50	3,7	09186 3
50-6-22	931186	vn	ZD	NS	7/8	22,0	77,0	8,0	50	3,9	09187 0
50-L-13	915213	vn	ZD	NS	1/2	13,0	76,0	10,0	50	2,7	09160 3
50-L-19	915304	vn	ZD	NS	3/4	19,0	83,0	10,0	50	2,8	09161 0
51-16	925835	vn	ZD	NS	5/8	16,0	96,0	11,0	50	6,1	09198 6
52-25	931194	vn	ZD	NS	1	26,0	75,0	10,0	50	3,8	09150 4





50-S



50-S-6



52-S



149



49

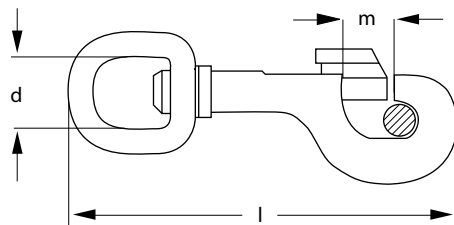

Name	Ident. no.	sur	Material		d		l mm	m mm	pack. unit	kg per 100 pcs	EAN-no. 4012053
			Body	Spring	inch	mm					
50-S-13	931187	vn	ZD	NS	1/2	13,0	79,0	10,0	100	3,9	09190 0
50-S-16	931188	vn	ZD	NS	5/8	16,0	79,5	10,0	50	4,0	09191 7
50-S-19	931189	vn	ZD	NS	3/4	19,0	87,0	10,0	50	4,4	09192 4
50-S-22	931190	vn	ZD	NS	7/8	22,0	88,0	10,0	50	4,4	09193 1
50-S-25	931191	vn	ZD	NS	1	26,0	93,0	10,0	50	4,5	09194 8
50-S-6-19	931192	vn	ZD	NS	3/4	19,0	79,0	11,0	50	4,2	09196 2
50-S-6-22	931193	vn	ZD	NS	7/8	22,0	83,0	11,0	50	4,4	09197 9
52-S-25	931195	vn	ZD	NS	1	26,0	79,0	7,5	50	4,2	09151 1
149-10	900758	vn	ZD	NS	3/8	10,0	53,0	6,0	200	1,0	09140 5
149-12	908910	vn	ZD	NS	1/2	13,5	56,0	6,5	200	1,1	09141 2
49-12	931179	vn	ZD	NS	1/2	13,0	65,0	7,0	100	1,8	09235 8

# Snap Hook



50-MS-L



50-MS

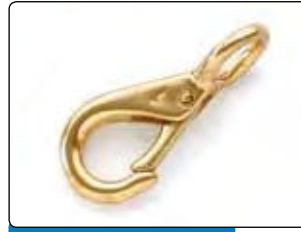

126-MS



127-MS



2317-MS

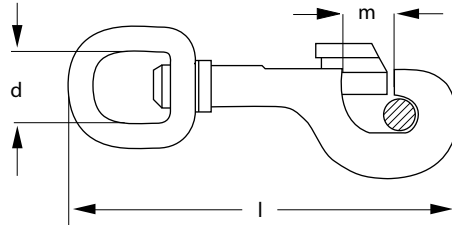

Name	Ident. no.	sur	body mat.	d		l	m	pack. unit	kg per 100 pcs	EAN-no. 4012053
				inch	mm					
50-MS-L-13	906760	bl	MS	1/2	13,0	76,0	6,5	100	3,1	10780 9
50-MS-16	903666	bl	MS	5/8	16,0	78,0	8,0	50	5,4	10781 7
50-MS-19	910920	bl	MS	3/4	19,0	80,0	10,0	50	5,6	10782 3
50-MS-25	932831	bl	MS	1	26,0	90,0	10,0	50	5,8	10783 0
126-MS-16	907448	bl	MS	5/8	16,0	72,0	9,0	50	4,5	11270 4
126-MS-19	904854	bl	MS	3/4	19,0	96,0	12,0	25	11,3	11271 1
127-MS-16	900999	bl	MS	5/8	18,0	85,0	9,0	50	6,4	11272 8
127-MS-19	911398	bl	MS	3/4	20,0	94,0	12,0	25	8,2	11273 5
2317-MS-19	900190	bl	MS	3/4	19,0	102,0	17,0	25	14,1	11280 3

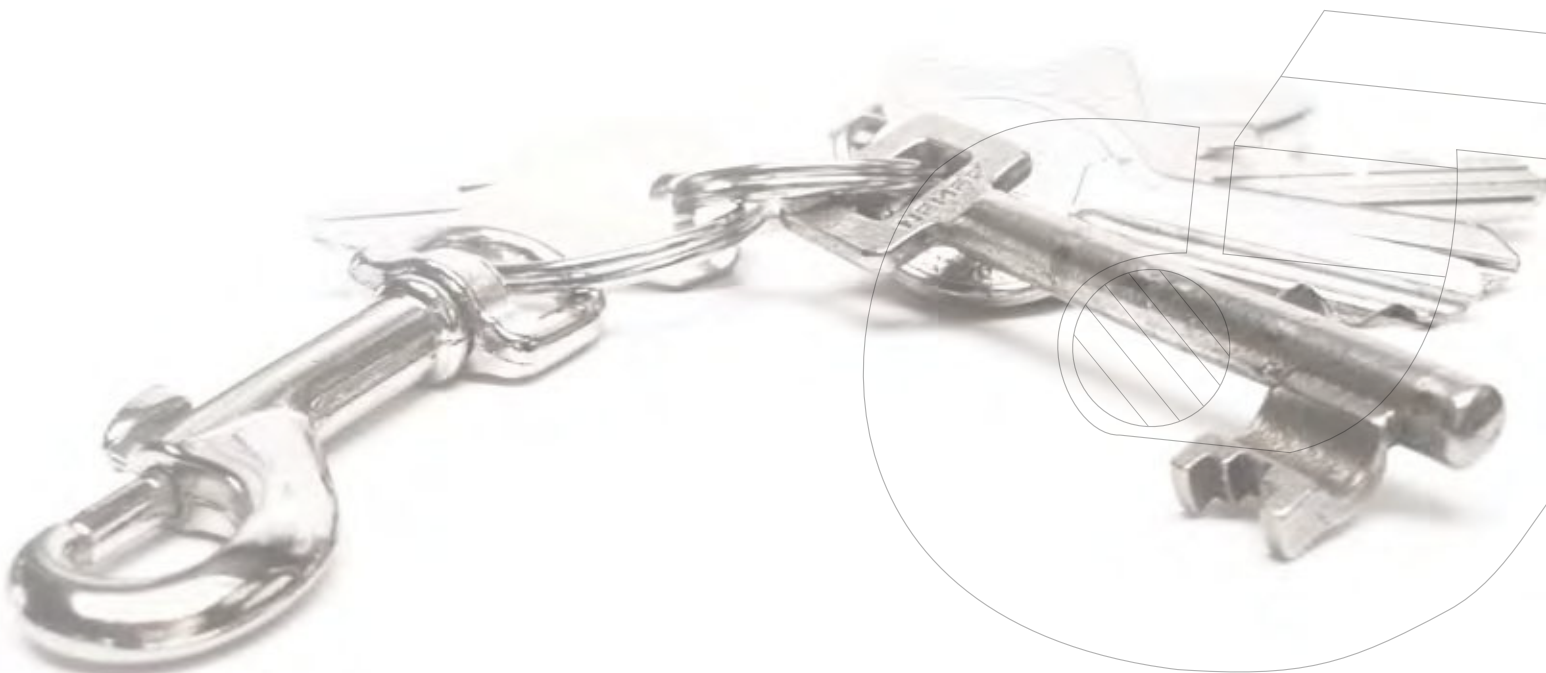



55



47 / 57



47-6 / 57-6



58



59

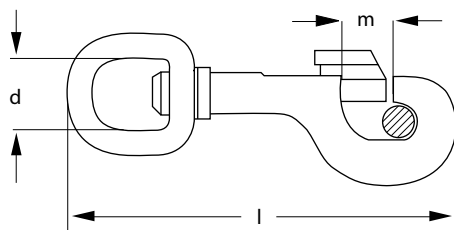

Name	Ident. no.	sur	Material		d		l	m	pack. unit	kg per 100 pcs	EAN-no. 4012053
			Body	Spring	inch	mm					
55-28	924047	vn	ZD	NS	1 1/8	28,0	100,0	11,0	20	6,8	09221 1
47-13	931174	vn	ZD	NS	1/2	13,0	68,0	8,5	50	2,3	09230 3
47-16	931175	vn	ZD	NS	5/8	16,0	73,0	8,8	50	2,5	09231 0
47-19	931178	vn	ZD	NS	3/4	19,0	76,0	8,5	50	2,8	09232 7
57-16	931196	vn	ZD	NS	5/8	16,0	88,0	11,0	20	4,1	09240 2
57-19	931197	vn	ZD	NS	3/4	19,0	90,0	11,0	20	4,6	09241 9
47-6-16	931176	vn	ZD	NS	5/8	16,0	70,0	10,0	50	2,8	09233 4
47-6-19	931177	vn	ZD	NS	3/4	19,0	70,0	8,0	50	2,9	09234 1
57-6-19	931198	vn	ZD	NS	3/4	19,0	80,0	8,5	50	4,5	09242 6
58-25	931199	vn	ZD	NS	1	26,0	81,0	11,0	50	4,7	09244 0
59-16	950002	vn	ZD	NS	5/8	16,0	87,0	11,0	20	4,7	09253 2
59-19	931464	vn	ZD	NS	3/4	19,0	89,0	11,0	20	5,0	09245 7

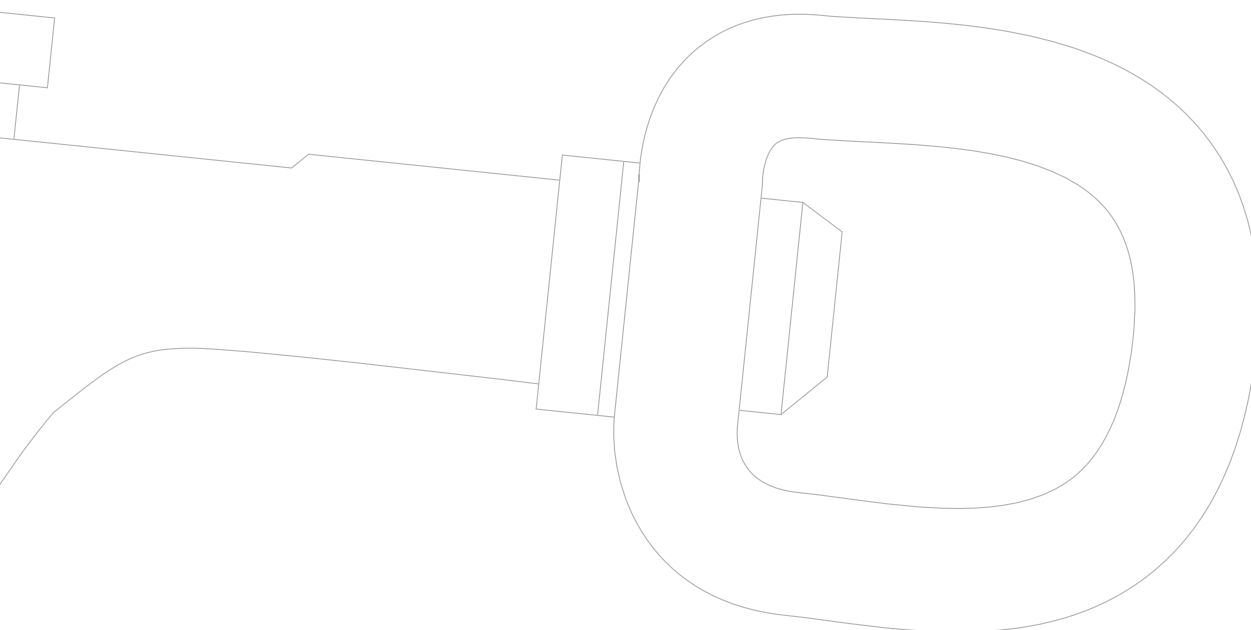

# Snap Hook



59-6



60



86



87



188

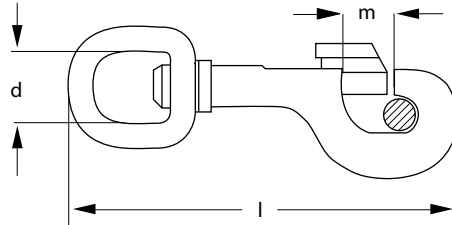

Name	Ident. no.	sur	Material		inch	d	l	m	pack. unit	kg per 100 pcs	EAN-no.
			Body	Spring							
59-6-19	931200	vn	ZD	NS	3/4	19,0	80,0	8,5	50	3,6	4012053 09250 1
60-25	931201	vn	ZD	NS	1	26,0	80,0	11,0	50	4,4	09251 8
86-16	924514	vn	ZD	NS	5/8	16,0	90,0	12,0	25	4,0	09280 8
86-19	924515	vn	ZD	NS	3/4	19,0	94,0	12,0	25	4,6	09281 5
87-22	933842	vn	ZD	NS	7/8	22,0	85,0	12,0	25	4,4	09282 2
87-25	933843	vn	ZD	NS	1	26,0	85,0	12,0	25	4,6	09283 9
188-16	916360	vn	ZD	NS	5/8	16,0	85,0	9,0	50	4,9	09200 6
188-19	916361	vn	ZD	NS	3/4	19,0	90,0	9,0	25	5,3	09201 3





4218



5054



65



72

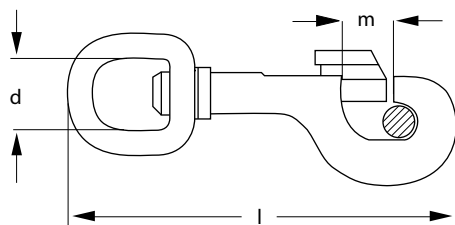

Name	Ident. no.	sur	Material Body	d		l mm	m mm	pack. unit	kg per 100 pcs	EAN-no. 4012053
				inch	mm					
4218-1-10	910789	vn	ZD	3/8	10,0	60,0	14,0	100	2,3	09310 2
4218-2-13	904894	vn	ZD	1/2	13,0	65,0	15,0	50	4,3	09311 9
4218-2-20	907826	vn	ZD	3/4	19,0	68,0	16,0	50	4,8	09312 6
5054-50-80	906245	vn	ZD	-	11,0	50/80	4,0	50	1,8	09320 1
5054-60-95	910345	vn	ZD	-	11,0	60/95	4,5	50	2,7	09321 8
5054-70-110	905174	vn	ZD	-	16,0	70/110	5,0	50	3,7	09322 5
5054-85-130	927962	vn	ZD	-	19,0	85/130	5,5	50	5,0	09323 2
65-16	904903	vn	ZD	5/8	15,0	86,0	11,0	50	3,5	09270 9
65-19	933832	vn	ZD	3/4	19,0	90,0	12,0	50	3,9	09273 0
72-090	910739	vn	ZD	-	-	90,0	8,5	50	3,4	09271 6
72-105	910640	vn	ZD	-	-	105,0	11,0	50	4,2	09272 3
72-115	933833	vn	ZD	-	-	115,0	8,5	50	6,9	09274 7



# Snap Hook



100



126



135 / 155

Name	Ident. no.	sur	Material Body	d inch	d mm	l mm	m mm	pack. unit	kg per 100 pcs	EAN-no. 4012053
100-22	923666	vn	ZD	7/8	22,0	60,0	9,0	25	4,4	09290 7
100-25	923667	vn	ZD	1	26,0	60,0	9,0	25	4,5	09291 4
126-050	916365	vz	ZD	3/8	11,0	50,0	7,0	100	1,8	09260 0
126-060	916355	vz	ZD	1/2	12,0	60,0	8,0	100	2,9	09261 7
126-070	916356	vz	ZD	9/16	14,5	70,0	11,0	50	4,1	09262 4
126-085	916357	vz	ZD	11/16	17,5	85,0	12,5	20	7,4	09263 1
126-100	916358	vz	ZD	13/16	21,0	100,0	16,0	20	12,0	09264 8
126-120	916359	vz	ZD	1	25,0	120,0	19,0	10	19,7	09265 5
135-19	924516	vn	ZD	3/4	19,0	77,0	13,0	50	2,5	09292 1
135-25	924049	vn	ZD	1	26,0	77,0	13,0	25	3,7	09293 8
155-14	914379	vn	ZD	9/16	14,0	47,0	5,5	200	0,8	09294 5
155-16	904134	vn	ZD	5/8	16,0	43,0	5,5	200	0,9	09295 2



50-5-R



50-L-13-R



49-12-R

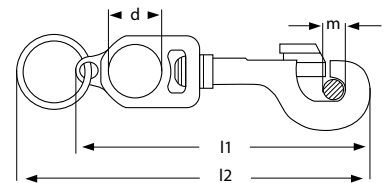

Name	Ident. no.	sur	body mat.	d mm	l1 mm	l2 mm	m mm	pack. unit	kg per 100 pcs	EAN-no. 4012053
50-5-R	931183	vn	ZD	25	74,0	98,0	9,0	50	3,2	09163 4
50-L-13-R	907662	vn	ZD	25	76,0	93,0	10,0	50	2,8	09162 7
49-12-R	931180	vn	ZD	25	67,5	90,0	7,5	100	1,9	09236 5



163



178

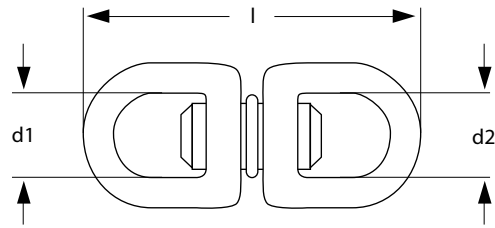

Name	Ident. no.	sur	body mat.	d1 mm	d2 mm	l mm	Wire mm	pack. unit	kg per 100 pcs	EAN-no.
163-09-13	923631	vn	ZD	9,0	13,0	43,0	-	200	1,5	09300 3
163-09-16	923632	vn	ZD	9,0	16,0	45,0	-	100	1,9	09305 8
178-13-13	924709	vn	ZD	13,0	13,0	52,0	4,5	100	2,3	09301 0
178-16-16	924710	vn	ZD	16,0	16,0	62,0	4,5	50	3,3	09302 7
178-20-20	924711	vn	ZD	20,0	20,0	70,0	5,0	50	3,4	09303 4
178-25-25	924713	vn	ZD	25,0	25,0	78,5	5,5	25	4,3	09304 1



166

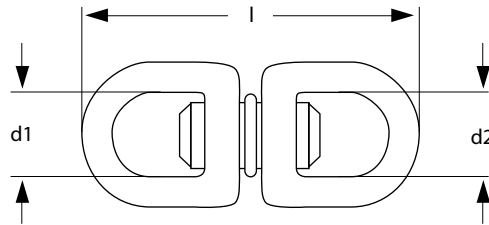

Name	Ident. no.	sur	body mat.	l mm	d1 mm	d2 mm	pack. unit	kg per 100 pcs	EAN-no.
166-45	914112	vn	TG	46,0	13,5	7,5	100	2,8	10171 5
166-60	900395	vn	TG	58,0	17,5	10,0	50	4,5	10172 2
166-70	912897	vn	TG	70,0	19,0	13,0	50	5,2	10173 9
166-80	902205	vn	TG	84,0	25,0	11,5	25	10,5	10174 6

## INOX



178-I

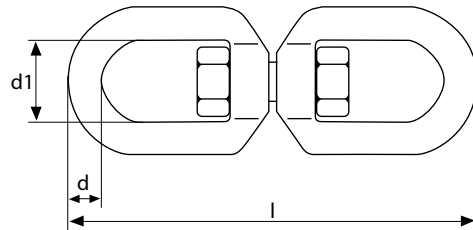

Name	Ident. no.	sur	body mat.	d mm	d1 mm	d2 mm	l mm	pack. unit	kg per 100 pcs	EAN-no.
178-I-05	933891	po	A4	5,0	13,0	13,0	59,0	20	3,9	13020 3
178-I-06	933892	po	A4	6,0	15,0	15,0	66,0	10	5,5	13021 0
178-I-08	933893	po	A4	8,0	20,0	20,0	90,0	10	12,0	13022 7
178-I-10	933894	po	A4	10,0	24,0	24,0	114,0	10	24,5	13023 4

# Swivel / Quick release snap hook

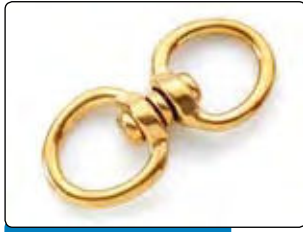

178-MS



167-MS

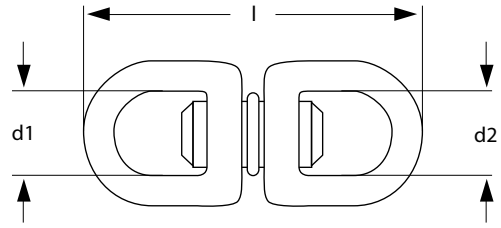

Name	Ident. no.	sur	body mat.	l mm	d1 mm	d2 mm	pack. unit	kg per 100 pcs	EAN-no.
178-MS-25-25	902580	bl	MS	85,0	25,0	25,0	25	7,0	4012053 11300 8
167-MS-50	930018	bl	MS	51,0	10,0	10,0	50	2,5	11290 2
167-MS-90	930019	bl	MS	56,0	13,0	13,0	25	7,3	11291 8



1001



1051



1200

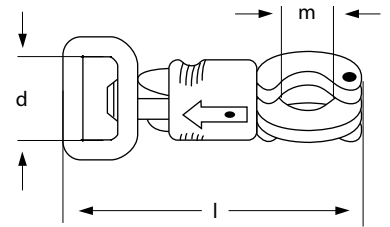

Name	Ident. no.	sur	body mat.	d mm	l mm	m mm	pack. unit	kg per 100 pcs	EAN-no.
1001-13	924758	vz	ZD	13,0	104,0	22,0	10	14,1	4012053 09330 0
1051-25	950001	vn	ZD	26,0	122,0	22,0	10	16,1	09332 4
1200	932328	vz	NO	13,0	98,0	22,0	10	17,6	09331 7





245



245 (DIN 5299 C)

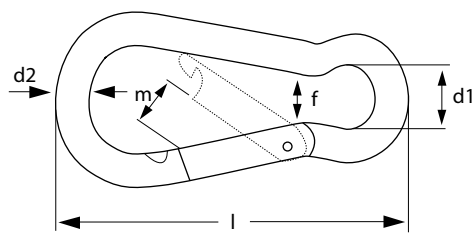

Name	Ident. no.	sur	body mat.	l mm	d1 mm	d2 mm	f mm	m mm	SWL daN	pack. unit	kg per 100 pcs	EAN-no. 4012053
245-040-04	909400	vz	NO	40	6	4	5	6	60	200	0,8	09900 5
245-050-05	901626	vz	NO	50	8	5	6	7	70	200	1,6	09890 9
245-060-06	905971	vz	NO	60	9	6	7	8	90	100	2,7	09891 6
245-070-07	911554	vz	NO	70	10	7	8	10	130	50	4,3	09892 3
245-080-08	907137	vz	NO	80	11	8	9	11	140	50	6,7	09893 0
245-090-09	911627	vz	NO	90	13	9	10	12	150	25	9,4	09894 7
245-100-10	907208	vz	NO	100	16	10	12	12	170	25	12,7	09895 4
245-120-11	905986	vz	NO	120	17	11	13	19	230	20	19,0	09896 1
245-140-12	910070	vz	NO	140	20	12	16	20	250	10	25,8	09897 8
245-160-13	910834	vz	NO	160	22	13	17	26	300	10	35,1	09898 5
245-180-14	922496	vz	NO	180	22	14	17	29	400	5	48,6	09903 6
245-200-15	933798	vz	NO	200	26	15	17	39	500	5	61,8	09902 9
245-050-05 DIN 5299 C 925154		vz	NO	50	8	5	5	7	120	100	1,6	09880 0
245-060-06 DIN 5299 C 925157		vz	NO	60	9	6	6	7	120	50	2,7	09881 7
245-070-07 DIN 5299 C 925159		vz	NO	70	10	7	8	10	180	50	4,3	09882 4
245-080-08 DIN 5299 C 925161		vz	NO	80	11	8	9	12	230	25	6,7	09883 1
245-090-09 DIN 5299 C 925163		vz	NO	90	13	9	11	11	250	25	9,4	09884 8
245-100-10 DIN 5299 C 925165		vz	NO	100	16	10	12	12	350	25	12,7	09885 5
245-120-11 DIN 5299 C 925167		vz	NO	120	17	11	13	19	450	10	19,0	09886 2
245-140-12 DIN 5299 C 925169		vz	NO	140	20	12	16	20	510	5	25,8	09887 9
245-160-13 DIN 5299 C 925171		vz	NO	160	23	13	17	29	600	5	35,1	09888 6



2450

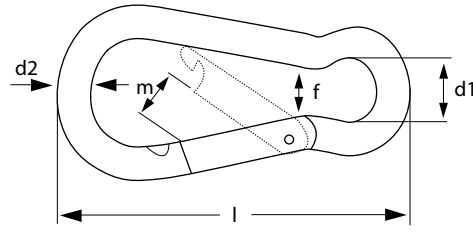

245 S



2450 S

Name	Ident. no.	sur	body mat.	l mm	d1 mm	d2 mm	f mm	m mm	SWL daN	pack. unit	kg per 100 pcs	EAN-no. 4012053
2450-060-06	927937	vz	NO	60	7,0	6,0	-	7,0	90	100	2,5	09910 4
2450-080-08	927936	vz	NO	80	10,0	8,0	-	11,0	140	50	6,2	09911 1
2450-100-10	927923	vz	NO	100	12,0	10,0	-	12,0	170	25	13,4	09912 8
2450-120-11	933800	vz	NO	120	16,0	11,0	-	19,0	230	20	19,1	09913 5
245-S-070-07	927938	vz	NO	70	10,0	7,0	8,0	7,5	130	50	4,4	09920 3
245-S-080-08	927939	vz	NO	80	11,0	8,0	9,0	8,5	140	50	6,8	09921 0
245-S-090-09	927940	vz	NO	90	13,0	9,0	11,0	9,0	150	25	9,6	09922 7
245-S-100-10	927941	vz	NO	100	16,0	10,0	12,0	10,0	170	25	12,8	09923 4
245-S-120-11	927942	vz	NO	120	17,0	11,0	13,0	16,0	230	20	19,1	09924 1
245-S-140-12	927943	vz	NO	140	20,0	12,0	16,0	18,0	250	10	25,5	09925 8
245-S-160-13	933799	vz	NO	160	22,0	13,0	17,0	23,0	300	5	36,6	09926 5
245-S-180-14	933805	vz	NO	180	22,0	14,0	16,0	29,0	400	5	51,0	09927 2
2450-S-070-07	933801	vz	NO	70	10,0	7,0	-	9,0	-	100	2,5	10596 6
2450-S-080-08	933802	vz	NO	80	11,0	8,0	-	12,0	-	50	6,2	10597 3
2450-S-100-10	933803	vz	NO	100	11,0	10,0	-	12,0	-	25	13,4	10598 0
2450-S-120-11	933804	vz	NO	120	18,0	11,0	-	17,0	-	20	19,1	10599 7



246



226



226 S



128

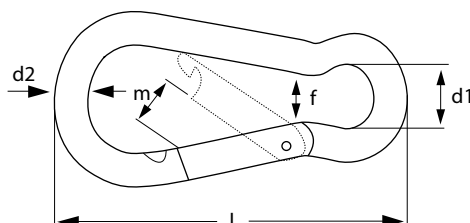

Name	Ident. no.	sur	body mat.	l mm	d1 mm	d2 mm	f mm	m mm	pack. unit	kg per 100 pcs	EAN-no. 4012053
246-060-06	924577	vz	NO	60	9,0	6,0	9,5	8,0	100	2,6	09930 2
246-070-07	924578	vz	NO	70	11,0	7,0	14,0	8,0	50	4,4	09931 9
246-080-08	924579	vz	NO	80	14,0	8,0	14,0	9,0	50	6,2	09932 6
246-100-10	924580	vz	NO	100	16,0	10,0	18,0	14,0	20	14,5	09933 3
246-120-11	931207	vz	NO	120	16,0	11,0	20,0	18,0	20	18,2	09934 0

approx. DIN 5299 E

226-060-06	931208	vz	NO	60	9,0	6,0	-	7,0	50	2,8	09940 1
226-070-07	931209	vz	NO	70	10,0	7,0	-	9,0	25	4,7	09941 8
226-080-08	931210	vz	NO	80	12,0	8,0	-	10,0	25	6,4	09942 5
226-100-10	933841	vz	NO	100	15,0	10,0	-	13,0	10	13,1	09943 2

approx. DIN 5299 E

226-S-060-06	933834	vz	NO	60	9,0	6,0	-	6,0	50	2,8	09953 1
226-S-070-07	931211	vz	NO	70	10,0	7,0	-	8,0	20	4,9	09950 0
226-S-080-08	931212	vz	NO	80	12,0	8,0	-	8,0	20	6,8	09951 7
226-S-100-10	931359	vz	NO	100	15,0	10,0	-	12,0	10	14,2	09952 4

128-070-07	916643	vz	NO	70	11,0	7,0	11,0	-	100	4,0	09960 9
128-080-08	916644	vz	NO	80	12,5	8,0	11,0	-	50	5,3	09961 6
128-090-09	916645	vz	NO	90	13,5	10,0	14,0	-	25	8,7	09962 3

# Snap Hook

INOX



245-I

INOX



2450-I

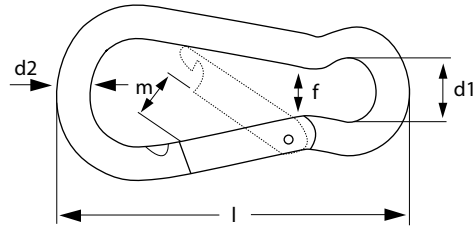

Name	Ident. no.	sur	body mat.	l mm	d1 mm	d2 mm	f mm	m mm	SWL daN	pack. unit	kg per 100 pcs	EAN-no. 4012053
245-I-050-05	920719	po	A4	50	8,0	5,0	6,5	7,0	95	50	1,7	10570 6
245-I-060-06	920720	po	A4	60	8,5	6,0	6,5	8,0	105	50	2,8	10571 3
245-I-070-07	920721	po	A4	70	10,0	7,0	7,5	9,5	155	25	4,0	10572 0
245-I-080-08	920722	po	A4	80	11,5	8,0	7,5	10,0	185	20	6,4	10573 7
245-I-100-10	920724	po	A4	100	16,0	10,0	11,0	13,5	260	10	12,4	10574 4
245-I-120-11	920725	po	A4	120	19,5	11,0	14,0	17,5	360	10	18,2	10575 1
2450-I-050-05	920726	po	A4	50	6,0	5,0	-	6,0	95	50	1,7	10590 4
2450-I-060-06	920727	po	A4	60	6,0	6,0	-	8,0	105	50	2,8	10591 1
2450-I-070-07	920728	po	A4	70	8,0	7,0	-	9,0	155	25	4,0	10592 8
2450-I-080-08	920729	po	A4	80	11,0	8,0	-	10,0	185	20	6,4	10593 5
2450-I-100-10	920731	po	A4	100	14,0	10,0	-	11,0	260	10	12,4	10594 2
2450-I-120-11	920732	po	A4	120	17,0	11,0	-	17,0	360	10	18,2	10595 9







245-IS



2450-IS



2450-IR-Lock



246-I



247-I

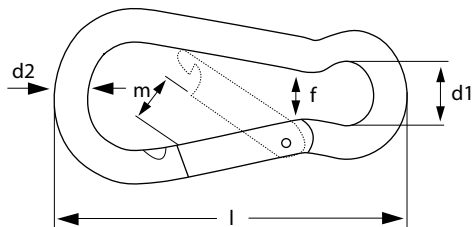

Name	Ident. no.	sur	body mat.	l mm	d1 mm	d2 mm	f mm	m mm	SWL daN	pack. unit	kg per 100 pcs	EAN-no. 4012053
245-IS-080-08	930001	po	A4	80,0	11,5	8,0	9,0	8,0	-	20	6,9	10580 5
245-IS-100-10	930002	po	A4	100,0	15,0	10,0	9,0	11,0	-	10	13,1	10581 2
245-IS-120-11	930003	po	A4	120,0	16,0	11,0	13,0	17,0	-	5	19,2	10582 9
2450-IS-080-08	930010	po	A4	80,0	10,0	8,0	-	7,0	-	20	6,6	10600 0
2450-IS-100-10	930011	po	A4	100,0	13,5	10,0	-	10,0	-	10	13,5	10601 9
2450-IS-120-11	930012	po	A4	120,0	15,0	11,0	-	15,0	-	5	18,9	10602 4
2450-IR-Lock-100-10	931647	po	A4	100,0	13,0	10,0	-	12,0	-	10	13,6	10630 7
246-I-060-06	930004	po	A4	60,0	9,0	6,0	-	9,0	-	25	2,7	10680 2
247-I-060-06	930005	po	A4	60,0	8,0	6,0	-	10,0	-	25	3,0	10690 1
247-I-080-08	930006	po	A4	80,0	12,0	8,0	-	12,0	-	20	7,1	10691 8
247-I-100-10	930007	po	A4	100,0	15,0	10,0	-	18,0	-	10	13,8	10692 5
247-I-120-11	930008	po	A4	120,0	19,0	11,0	-	24,0	-	5	19,7	10693 2

# Snap Hook



INOX

2470-I



INOX

2470-IR-Lock



INOX

2490-I



INOX

2315-I

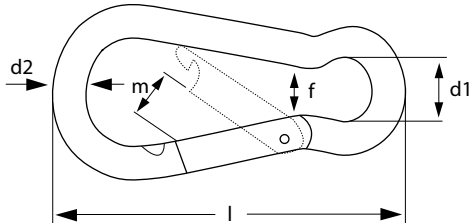

Name	Ident. no.	sur	body mat.	l mm	d1 mm	d2 mm	m mm	pack. unit	kg per 100 pcs	EAN-no. 4012053
2470-I-060-06	930013	po	A4	60,0	6,0	6,0	10,0	25	3,1	10640 6
2470-I-080-08	930014	po	A4	80,0	10,0	8,0	12,0	20	7,2	10641 3
2470-I-100-10	930015	po	A4	100,0	14,0	10,0	18,0	10	13,6	10642 0
2470-I-120-11	930016	po	A4	120,0	17,0	11,0	24,0	5	19,9	10643 7
2470-IR-Lock100-10	930017	po	A4	100,0	12,0	10,0	18,0	10	14,4	10631 4
2490-I-090	930057	po	A4	90,0	10,0	9,0	19,0	20	10,7	10650 5
2315-I-050	915897	po	A4	50,0	6,0	-	11,0	50	2,1	10830 1
2315-I-070	915898	po	A4	70,0	9,0	-	11,5	25	5,0	10831 8
2315-I-100	915899	po	A4	100,0	13,5	-	11,5	20	14,5	10832 5



2118



5297

Name	Ident. no.	sur	body mat.	l mm	d1 mm	m mm	SWL daN	BS daN	pack. unit	kg per 100 pcs	EAN-no. 4012053
2118-38	932097	sc	NO	72,0	39,0	9,0	-	300	25	5,1	09990 6
5297-20	930020	vz	NO	58,0	20,0	7,0	150	320	50	4,2	10461 7



115 D



4292-1/2



4293



4293-1/2



5001



4293-1/2-1

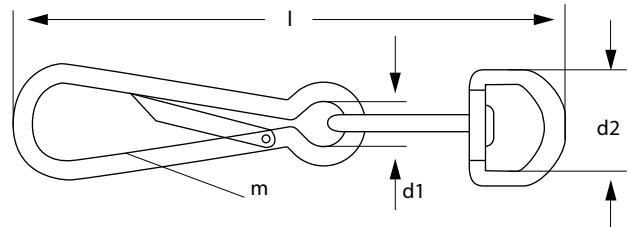

Name	Ident. no.	sur	body mat.	d1 mm	d2 mm	m mm	l mm	pack. unit	kg per 100 pcs	EAN-no. 4012053
115-D-16	931930	ge	NO	16	-	9,0	75	50	3,2	09810 7
115-D-20	933887	ge	NO	20	-	10,0	79	100	3,6	09118 4
4292-1/2-60	917736	vz	NO	9	-	6,0	60	250	0,8	09800 8
4293-025	933674	vn	NO	5	8	3,5	25/50	500	0,4	09809 1
4293-030	902054	vn	NO	5	10	4,0	30/57	500	0,4	09801 5
4293-040	901818	vn	NO	7	11	5,5	40/68	500	0,7	09802 2
4293-050	901792	vn	NO	8	12	6,5	50/83	250	1,1	09803 9
4293-060	901786	vn	NO	10	13	7,0	60/95	250	1,4	09804 6
4293-070	901723	vn	NO	10	16	8,0	70/107	200	2,3	09806 0
4293-080	901686	vn	NO	10	16	9,0	80/126	100	3,3	09807 7
4293-090	934734	vn	NO	13	21	10,0	90/138	100	4,4	12131 7
4293-100	901629	vn	NO	14	19	10,0	100/148	25	5,4	09808 4
4293-120	901630	vn	NO	15	22	12,0	120/170	25	4,4	09719 3
4293-1/2-040	901332	vn	NO	7	-	5,5	40	500	0,4	09811 4
4293-1/2-060	903461	vn	NO	10	-	7,5	60	200	1,4	09812 1
4293-1/2-080	901129	vn	NO	12	-	10,0	80	100	3,3	09813 8
4293-1/2-100	900976	vn	NO	14	-	11,0	100	50	5,4	09814 5
5001-040	917823	vn	NO	6	12	5,0	42/71	250	1,1	10430 3
5001-050	917824	vn	NO	7	12	5,0	50/79	250	1,3	10431 0
5001-060	917825	vn	NO	8	15	6,0	60/90	100	2,2	10432 7
5001-070	917826	vn	NO	8	15	8,0	70/100	100	3,3	10433 4
4293-1/2-1-40	901924	po	A4	7,0	-	5,5	40	200	0,4	10670 3

# Snap Hook / Eight



5002



5003



3-A

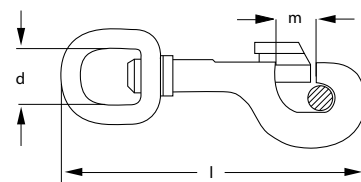

Name	Ident. no.	sur	body mat.	d mm	m mm	l mm	pack. unit	kg per 100 pcs	EAN-no. 4012053
5002-040	917827	vn	NO	13,0	4,0	45	200	0,6	10440 2
5002-050	917828	vn	NO	16,0	6,0	50	200	0,9	10441 9
5002-060	917829	vn	NO	16,0	6,0	60	200	1,5	10442 6
5002-070	917830	vn	NO	16,0	8,0	75	100	2,2	10443 3
5002-080	917831	vn	NO	18,0	9,0	80	100	2,8	10444 0
5003-050	917832	vn	NO	20,0	5,0	50	200	1,2	10450 1
5003-060	917833	vn	NO	20,0	6,0	60	200	1,8	10451 8
3-A-60-6	934955	vz	NO	13,0	6,0	60	50	3,2	09849 7
3-A-70-6	907666	vz	NO	13,5	6,0	70	50	3,4	09850 3
3-A-75-7	906960	vz	NO	17,0	7,0	75	20	5,8	09851 0
3-A-80-8	933844	vz	NO	18,0	8,0	80	20	8,6	09852 7





240R silver



240R blue



240R violett



240R green



240R red



240R black

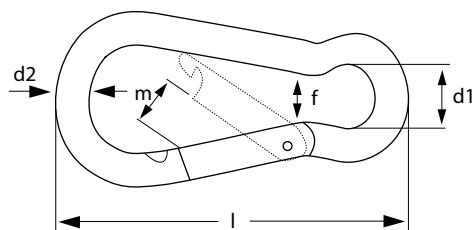

Name	Ident. no.	sur	body mat.	color	l mm	d1 mm	d2 mm	f mm	m mm	pack. unit	kg per 100 pcs	EAN-no. 4012053
240R-60-06	950174	el	LM	fs	60,0	10,0	5,5	7,5	12,0	10	0,9	93836
240R-60-06	950175	el	LM	fb	60,0	10,0	5,5	7,5	12,0	10	0,9	93843
240R-60-06	950176	el	LM	fv	60,0	10,0	5,5	7,5	12,0	10	0,9	93850
240R-60-06	950177	el	LM	fg	60,0	10,0	5,5	7,5	12,0	10	0,9	93867
240R-60-06	950178	el	LM	fr	60,0	10,0	5,5	7,5	12,0	10	0,9	93874
240R-60-06	950179	el	LM	fz	60,0	10,0	5,5	7,5	12,0	10	0,9	93881



2922R silver



2922R blue



2922R violett



2922R green



2922R red



2922R black



2922 blue

Name	Ident. no.	sur	body mat.	color	l mm	h mm	H mm	d2 mm	m mm	pack. unit	kg per 100 pcs	EAN-no. 4012053
2922R-80-08	950074	el	LM	fs	77,0	16,0	25,5	7,5	17,0	10	2,3	105003
2922R-80-08	950075	el	LM	fb	77,0	16,0	25,5	7,5	17,0	10	2,3	105010
2922R-80-08	950076	el	LM	fv	77,0	16,0	25,5	7,5	17,0	10	2,3	105027
2922R-80-08	950077	el	LM	fg	77,0	16,0	25,5	7,5	17,0	10	2,3	105034
2922R-80-08	950078	el	LM	fr	77,0	16,0	25,5	7,5	17,0	10	2,3	105041
2922R-80-08	950079	el	LM	fz	77,0	16,0	25,5	7,5	17,0	10	2,3	105058

2922-80-08	950080	el	LM	fb	77,0	16,0	25,5	7,5	17,0	10	2,0	105065
------------	--------	----	----	----	------	------	------	-----	------	----	-----	--------



258-GE

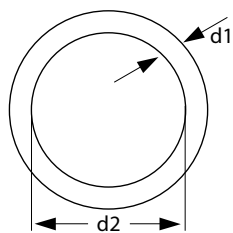

Name	Ident. no.	sur	body mat.	d2 mm	d1 mm	pack. unit	kg per 100 pcs	EAN-no. 4012053
258-35-07	917842	vz	NO	35,0	7,0	100	4,2	10263 7
258-40-05	933919	vz	NO	40,0	5,0	100	2,2	10264 4
258-40-06	917844	vz	NO	40,0	6,0	100	3,3	10265 1
258-40-08	933920	vz	NO	40,0	8,0	50	6,2	10266 8
258-40-09	933921	vz	NO	40,0	9,0	50	7,9	10267 5
258-40-10	933922	vz	NO	40,0	10,0	25	9,6	10268 2
258-45-09	933931	vz	NO	45,0	9,0	50	8,8	10269 9
258-50-05	933923	vz	NO	50,0	5,0	100	2,8	10980 3
258-50-08	933924	vz	NO	50,0	8,0	50	8,9	10981 0
258-50-09	933925	vz	NO	50,0	9,0	25	9,3	10982 7
258-50-10	933589	vz	NO	50,0	10,0	25	11,8	10260 6
258-50-12	933926	vz	NO	50,0	12,0	25	17,4	10983 4
258-60-06	933927	vz	NO	60,0	6,0	100	5,0	10984 1
258-60-08	933928	vz	NO	60,0	8,0	50	10,3	10985 8
258-60-09	933929	vz	NO	60,0	9,0	25	11,1	10986 5
258-60-10	933930	vz	NO	60,0	10,0	20	14,1	10987 2
258-60-12	933590	vz	NO	60,0	12,0	25	20,7	10261 3



258-MS

Name	Ident. no.	sur	body mat.	d1 mm	d2 mm	pack. unit	kg per 100 pcs	EAN-no. 4012053
258-MS-30-05	900683	bl	MS	5,0	32,0	100	2,3	11301 5



Rope & Chain

Safety

Tex

Tex Parts

# Snap Hook



245



245 (DIN 5299 C)

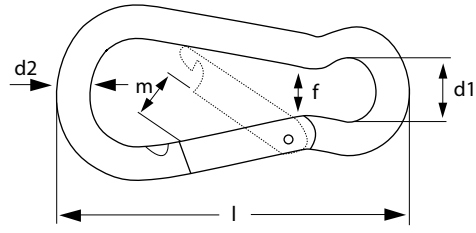

Name	Ident. no.	sur	body mat.	l mm	d1 mm	d2 mm	f mm	m mm	SWL daN	pack. unit	kg per 100 pcs	EAN-no. 4012053
245-040-04	909400	vz	NO	40	6	4	5	6	60	200	0,8	09900 5
245-050-05	901626	vz	NO	50	8	5	6	7	70	200	1,6	09890 9
245-060-06	905971	vz	NO	60	9	6	7	8	90	100	2,7	09891 6
245-070-07	911554	vz	NO	70	10	7	8	10	130	50	4,3	09892 3
245-080-08	907137	vz	NO	80	11	8	9	11	140	50	6,7	09893 0
245-090-09	911627	vz	NO	90	13	9	10	12	150	25	9,4	09894 7
245-100-10	907208	vz	NO	100	16	10	12	12	170	25	12,7	09895 4
245-120-11	905986	vz	NO	120	17	11	13	19	230	20	19,0	09896 1
245-140-12	910070	vz	NO	140	20	12	16	20	250	10	25,8	09897 8
245-160-13	910834	vz	NO	160	22	13	17	26	300	10	35,1	09898 5
245-180-14	922496	vz	NO	180	22	14	17	29	400	5	48,6	09903 6
245-200-15	933798	vz	NO	200	26	15	17	39	500	5	61,8	09902 9
245-050-05 DIN 5299 C	925154	vz	NO	50	8	5	5	7	120	100	1,6	09880 0
245-060-06 DIN 5299 C	925157	vz	NO	60	9	6	6	7	120	50	2,7	09881 7
245-070-07 DIN 5299 C	925159	vz	NO	70	10	7	8	10	180	50	4,3	09882 4
245-080-08 DIN 5299 C	925161	vz	NO	80	11	8	9	12	230	25	6,7	09883 1
245-090-09 DIN 5299 C	925163	vz	NO	90	13	9	11	11	250	25	9,4	09884 8
245-100-10 DIN 5299 C	925165	vz	NO	100	16	10	12	12	350	25	12,7	09885 5
245-120-11 DIN 5299 C	925167	vz	NO	120	17	11	13	19	450	10	19,0	09886 2
245-140-12 DIN 5299 C	925169	vz	NO	140	20	12	16	20	510	5	25,8	09887 9
245-160-13 DIN 5299 C	925171	vz	NO	160	23	13	17	29	600	5	35,1	09888 6





2450



245 S



2450 S

Name	Ident. no.	sur	body mat.	l mm	d1 mm	d2 mm	f mm	m mm	SWL daN	pack. unit	kg per 100 pcs	EAN-no. 4012053
2450-060-06	927937	vz	NO	60	7,0	6,0	-	7,0	90	100	2,5	09910 4
2450-080-08	927936	vz	NO	80	10,0	8,0	-	11,0	140	50	6,2	09911 1
2450-100-10	927923	vz	NO	100	12,0	10,0	-	12,0	170	25	13,4	09912 8
2450-120-11	933800	vz	NO	120	16,0	11,0	-	19,0	230	20	19,1	09913 5
245-S-070-07	927938	vz	NO	70	10,0	7,0	8,0	7,5	130	50	4,4	09920 3
245-S-080-08	927939	vz	NO	80	11,0	8,0	9,0	8,5	140	50	6,8	09921 0
245-S-090-09	927940	vz	NO	90	13,0	9,0	11,0	9,0	150	25	9,6	09922 7
245-S-100-10	927941	vz	NO	100	16,0	10,0	12,0	10,0	170	25	12,8	09923 4
245-S-120-11	927942	vz	NO	120	17,0	11,0	13,0	16,0	230	20	19,1	09924 1
245-S-140-12	927943	vz	NO	140	20,0	12,0	16,0	18,0	250	10	25,5	09925 8
245-S-160-13	933799	vz	NO	160	22,0	13,0	17,0	23,0	300	5	36,6	09926 5
245-S-180-14	933805	vz	NO	180	22,0	14,0	16,0	29,0	400	5	51,0	09927 2
2450-S-070-07	933801	vz	NO	70	10,0	7,0	-	9,0	-	100	2,5	10596 6
2450-S-080-08	933802	vz	NO	80	11,0	8,0	-	12,0	-	50	6,2	10597 3
2450-S-100-10	933803	vz	NO	100	11,0	10,0	-	12,0	-	25	13,4	10598 0
2450-S-120-11	933804	vz	NO	120	18,0	11,0	-	17,0	-	20	19,1	10599 7





246



226



226 S



128

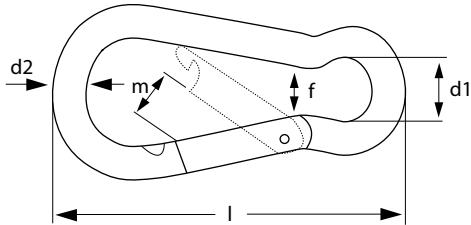

Name	Ident. no.	sur	body mat.	l mm	d1 mm	d2 mm	f mm	m mm	pack. unit	kg per 100 pcs	EAN-no. 4012053
246-060-06	924577	vz	NO	60	9,0	6,0	9,5	8,0	100	2,6	09930 2
246-070-07	924578	vz	NO	70	11,0	7,0	14,0	8,0	50	4,4	09931 9
246-080-08	924579	vz	NO	80	14,0	8,0	14,0	9,0	50	6,2	09932 6
246-100-10	924580	vz	NO	100	16,0	10,0	18,0	14,0	20	14,5	09933 3
246-120-11	931207	vz	NO	120	16,0	11,0	20,0	18,0	20	18,2	09934 0

approx. DIN 5299 E

226-060-06	931208	vz	NO	60	9,0	6,0	-	7,0	50	2,8	09940 1
226-070-07	931209	vz	NO	70	10,0	7,0	-	9,0	25	4,7	09941 8
226-080-08	931210	vz	NO	80	12,0	8,0	-	10,0	25	6,4	09942 5
226-100-10	933841	vz	NO	100	15,0	10,0	-	13,0	10	13,1	09943 2

approx. DIN 5299 E

226-S-060-06	933834	vz	NO	60	9,0	6,0	-	6,0	50	2,8	09953 1
226-S-070-07	931211	vz	NO	70	10,0	7,0	-	8,0	20	4,9	09950 0
226-S-080-08	931212	vz	NO	80	12,0	8,0	-	8,0	20	6,8	09951 7
226-S-100-10	931359	vz	NO	100	15,0	10,0	-	12,0	10	14,2	09952 4

128-070-07	916643	vz	NO	70	11,0	7,0	11,0	-	100	4,0	09960 9
128-080-08	916644	vz	NO	80	12,5	8,0	11,0	-	50	5,3	09961 6
128-090-09	916645	vz	NO	90	13,5	10,0	14,0	-	25	8,7	09962 3

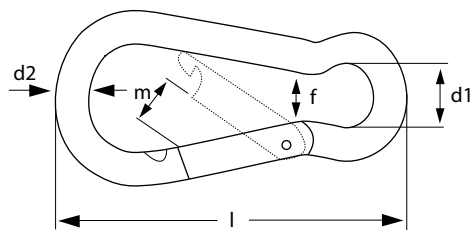

Name	Ident. no.	sur	body mat.	l mm	d1 mm	d2 mm	f mm	m mm	SWL daN	pack. unit	kg per 100 pcs	EAN-no. 4012053
245-I-050-05	920719	po	A4	50	8,0	5,0	6,5	7,0	95	50	1,7	10570 6
245-I-060-06	920720	po	A4	60	8,5	6,0	6,5	8,0	105	50	2,8	10571 3
245-I-070-07	920721	po	A4	70	10,0	7,0	7,5	9,5	155	25	4,0	10572 0
245-I-080-08	920722	po	A4	80	11,5	8,0	7,5	10,0	185	20	6,4	10573 7
245-I-100-10	920724	po	A4	100	16,0	10,0	11,0	13,5	260	10	12,4	10574 4
245-I-120-11	920725	po	A4	120	19,5	11,0	14,0	17,5	360	10	18,2	10575 1
2450-I-050-05	920726	po	A4	50	6,0	5,0	-	6,0	95	50	1,7	10590 4
2450-I-060-06	920727	po	A4	60	6,0	6,0	-	8,0	105	50	2,8	10591 1
2450-I-070-07	920728	po	A4	70	8,0	7,0	-	9,0	155	25	4,0	10592 8
2450-I-080-08	920729	po	A4	80	11,0	8,0	-	10,0	185	20	6,4	10593 5
2450-I-100-10	920731	po	A4	100	14,0	10,0	-	11,0	260	10	12,4	10594 2
2450-I-120-11	920732	po	A4	120	17,0	11,0	-	17,0	360	10	18,2	10595 9



# Snap Hook / Shackle



INOX

245-IS



INOX

2450-IS



INOX

2450-IR-Lock



INOX

246-I



INOX

247-I

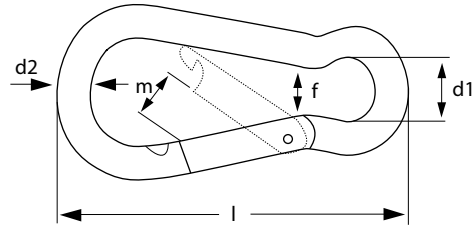

Name	Ident. no.	sur	body mat.	l mm	d1 mm	d2 mm	f mm	m mm	pack. unit	kg per 100 pcs	EAN-no. 4012053
245-IS-080-08	930001	po	A4	80,0	11,5	8,0	9,0	8,0	20	6,9	10580 5
245-IS-100-10	930002	po	A4	100,0	15,0	10,0	9,0	11,0	10	13,1	10581 2
245-IS-120-11	930003	po	A4	120,0	16,0	11,0	13,0	17,0	5	19,2	10582 9
2450-IS-080-08	930010	po	A4	80,0	10,0	8,0	-	7,0	20	6,6	10600 0
2450-IS-100-10	930011	po	A4	100,0	13,5	10,0	-	10,0	10	13,5	10601 9
2450-IS-120-11	930012	po	A4	120,0	15,0	11,0	-	15,0	5	18,9	10602 4
2450-IR-Lock-100-10	931647	po	A4	100,0	13,0	10,0	-	12,0	10	13,6	10630 7
246-I-060-06	930004	po	A4	60,0	9,0	6,0	-	9,0	25	2,7	10680 2
247-I-060-06	930005	po	A4	60,0	8,0	6,0	-	10,0	25	3,0	10690 1
247-I-080-08	930006	po	A4	80,0	12,0	8,0	-	12,0	20	7,1	10691 8
247-I-100-10	930007	po	A4	100,0	15,0	10,0	-	18,0	10	13,8	10692 5
247-I-120-11	930008	po	A4	120,0	19,0	11,0	-	24,0	5	19,7	10693 2



INOX

10000-I

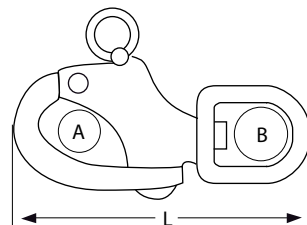

Name	Ident. no.	sur	body mat.	l mm	small eyelet (A) mm	big eyelet (B) mm	pack. unit	kg per 100 pcs	EAN-no. 4012053
10000-I-070	906817	po	A4	68,5	12,0	14,9	20	5,7	10840 0
10000-I-090	901265	po	A4	88,0	20,0	19,0	10	12,5	10841 7
10000-I-120	908734	po	A4	125,0	22,0	27,0	5	30,1	10842 4



2310



2311

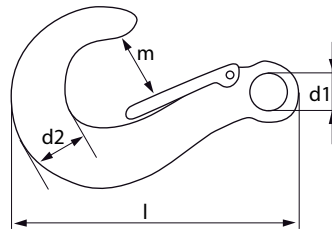

Name	Ident. no.	sur	body mat.	l mm	d1 mm	m mm	BS daN	pack. unit	kg per 100 pcs	EAN-no. 4012053
2310	923311	vz	NO	92,0	17,0	13,0	2500	25	15,8	09991 3
2311	902993	vz	NO	92,0	17,0	13,0	2500	20	16,0	09992 0



689



689-S

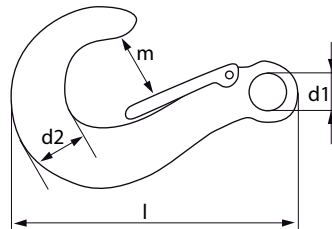

Name	Ident. no.	sur	body mat.	l mm	d1 mm	d2 mm	m mm	SWL daN	pack. unit	kg per 100 pcs	EAN-no. 4012053
689-1-bl	932074	bl	NO	90,0	12,0	7,5	18,0	250	10	15,2	09979 8
689-2-bl	932075	bl	NO	117,5	16,0	10,0	24,0	500	10	33,5	09971 5
689-3-bl	932076	bl	NO	160,5	20,0	13,5	33,0	1000	5	79,5	09972 2
689-4-bl	932077	bl	NO	190,5	26,0	16,0	39,0	1600	5	133,8	09973 9
689-1-vz	932078	vz	NO	90,0	12,0	7,5	18,0	250	10	15,2	09974 6
689-2-vz	932079	vz	NO	117,5	16,0	10,0	24,0	500	10	33,5	09975 3
689-3-vz	932080	vz	NO	160,5	20,0	13,5	33,0	1000	5	79,5	09976 0
689-4-vz	932081	vz	NO	190,5	26,0	16,0	39,0	1600	5	133,8	09977 7
689-S-1-bl	932082	bl	NO	90,0	12,0	7,5	18,0	250	10	15,2	09980 7
689-S-2-bl	932083	bl	NO	117,5	16,0	10,0	24,0	500	10	33,5	09981 4
689-S-3-bl	932084	bl	NO	160,5	20,0	13,5	33,0	1000	5	79,5	09982 1
689-S-4-bl	932085	bl	NO	190,5	26,0	16,0	39,0	1600	5	133,8	09983 8
689-S-1-vz	932086	vz	NO	90,0	12,0	7,5	18,0	250	10	15,2	09984 5
689-S-2-vz	932087	vz	NO	117,5	16,0	10,0	24,0	500	10	33,5	09985 2
689-S-3-vz	932088	vz	NO	160,5	20,0	13,5	33,0	1000	5	79,5	09986 9
689-S-4-vz	932089	vz	NO	190,5	26,0	16,0	39,0	1600	5	133,8	09987 6

INOX

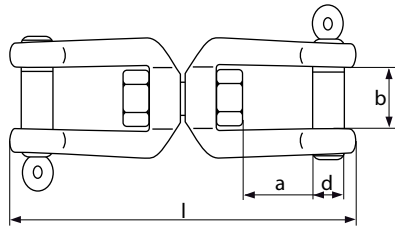

179-I

Name	Ident. no.	sur	body mat.	d mm	b mm	l mm	a mm	pack. unit	kg per 100 pcs	EAN-no. 4012053
179-I-06	933895	po	A4	6,0	12,0	66,0	11,0	10	5,9	13030 2
179-I-08	933896	po	A4	8,0	16,0	92,0	18,0	5	16,4	13031 9
179-I-10	933897	po	A4	10,0	20,0	112,0	24,5	5	28,8	13232 6

INOX



508-I

INOX



508-I-A

INOX



509-I

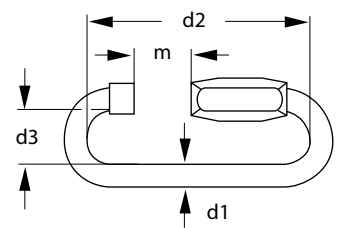

Name	Ident. no.	sur	body mat.	d1 mm	d2 mm	d3 mm	m mm	BS daN	SWL daN	pack. unit	kg per 100 pcs	EAN-no. 4012053
Professional article												
508-I-04 E	901610	po	A4	4,0	31,5	11,5	5,0	1400	280	50	1,6	10710 6
508-I-05 E	903413	po	A4	5,0	38,5	13,0	7,0	2250	450	50	2,1	10711 3
508-I-06 E	912234	po	A4	6,0	45,0	15,0	8,5	3250	650	50	3,5	10712 0
508-I-07 E	913854	po	A4	7,0	49,0	17,0	9,0	4500	900	25	5,5	10713 7
508-I-08 E	901565	po	A4	8,0	56,0	18,0	12,0	5500	1100	25	8,1	10714 4
508-I-10 E	902597	po	A4	10,0	69,0	21,0	12,5	9000	1800	10	14,3	10715 1
508-I-12 E	910299	po	A4	12,0	80,0	24,5	15,0	12500	2500	5	24,0	10716 8
Professional article												
508-I-A-04 E	904984	po	A4	4,0	44,5	12,0	11,5	1250	250	50	1,6	10730 4
508-I-A-05 E	906595	po	A4	5,0	51,0	13,5	13,5	2000	400	50	2,6	10731 1
508-I-A-06 E	914938	po	A4	6,0	58,5	14,5	16,0	2900	580	25	4,2	10732 8
508-I-A-07 E	908818	po	A4	7,0	64,5	17,0	16,5	4000	800	25	6,2	10733 5
508-I-A-08 E	903720	po	A4	8,0	71,5	18,0	17,5	4900	980	20	9,3	10734 2
508-I-A-10 E	912899	po	A4	10,0	85,0	21,0	21,0	8000	1600	20	16,0	10735 9
Professional article												
509-I-04 E	935050	po	A4	4,0	32,0	27,0	5,0	1000	200	100	1,4	10736 6

Name	Ident. no.	sur	body mat.	d1 mm	d2 mm	d3 mm	m mm	BS daN	SWL daN	pack. unit	kg per 100 pcs	EAN-no. 4012053
Consumer article												
508-I-04 F	926593	po	A2	4,0	32,0	11,5	5,5	-	90	50	1,6	10720 5
508-I-05 F	926594	po	A2	5,0	38,5	13,5	6,5	-	120	50	2,1	10721 2
508-I-06 F	926595	po	A2	6,0	47,0	15,0	8,5	-	180	25	3,5	10722 9
508-I-08 F	926596	po	A2	8,0	59,0	18,0	10,0	-	320	20	8,1	10723 6
508-I-10 F	928723	po	A2	10,0	70,0	20,5	12,5	-	420	10	14,3	10724 3
508-I-12 F	928724	po	A2	12,0	82,0	23,0	14,0	-	600	5	24,0	10725 0



508



508-A



509

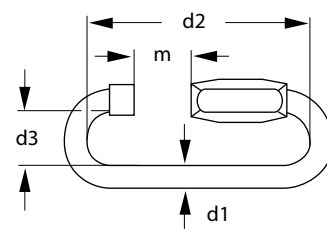

Name	Ident. no.	sur	body mat.	d1 mm	d2 mm	d3 mm	m mm	BS daN	pack. unit	kg per 100 pcs	EAN-no. 4012053
<b>Professional article</b>											
<b>DIN 56926 A</b>											
508-04	913209	vz	NO	4,0	32,0	11,5	5,5	900	200	1,2	10180 7
508-05	909330	vz	NO	5,0	38,5	13,0	6,5	1400	100	2,1	10186 9
508-06	901946	vz	NO	6,0	45,0	14,5	8,0	2000	100	4,8	10181 4
508-07	905674	vz	NO	7,0	50,0	16,0	9,0	2750	100	4,9	10185 2
508-08	903732	vz	NO	8,0	57,0	18,0	12,0	3500	100	7,7	10180 7
508-10	911380	vz	NO	10,0	68,0	21,0	13,0	5500	50	13,7	10183 8
508-12	909324	vz	NO	12,0	80,5	24,0	15,0	7500	25	21,8	10184 5
508-14	933773	vz	NO	14,0	93,0	27,0	18,0	11000	10	35,8	10187 6
508-16	933783	vz	NO	16,0	108,0	30,0	20,0	14500	10	55,8	10188 3
<b>Professional article</b>											
<b>DIN 56926 B</b>											
508-A-04	905097	vz	NO	4,0	45,0	11,5	11,0	800	100	1,5	10200 2
508-A-05	907289	vz	NO	5,0	51,0	13,0	13,5	1250	100	2,6	10201 9
508-A-06	911127	vz	NO	6,0	58,0	15,0	14,5	1750	50	4,1	10202 6
508-A-08	903225	vz	NO	8,0	72,0	18,0	18,0	3250	50	9,0	10203 3
508-A-10	903226	vz	NO	10,0	86,0	20,0	22,0	5000	25	15,9	10206 4
508-A-12	933570	vz	NO	12,0	99,0	24,0	23,5	6250	25	26,8	10204 0
<b>Professional article</b>											
509-04	904247	vz	NO	4,0	32,0	27,0	5,0	500	100	1,4	10210 1
509-06	902804	vz	NO	6,0	44,0	36,0	8,5	1250	100	3,8	10211 8
509-08	903754	vz	NO	8,0	55,5	40,0	11,5	2750	50	8,6	10212 5
509-10	915374	vz	NO	10,0	66,0	46,0	13,5	4500	50	15,2	10213 2
509-12	901922	vz	NO	12,0	80,0	49,0	15,0	5500	25	25,4	10214 9
509-14	901923	vz	NO	14,0	90,0	55,0	18,5	9000	25	39,7	10215 6

Name	Ident. no.	sur	body mat.	d1 mm	d2 mm	d3 mm	m mm	SWL daN	pack. unit	kg per 100 pcs	EAN-no. 4012053
<b>Consumer article</b>											
508-03,5	907965	vz	NO	3,5	28,0	10,0	5,0	80	200	0,8	10190 6
508-04	913010	vz	NO	4,0	32,0	10,0	5,0	90	200	1,2	10191 3
508-05	907084	vz	NO	5,0	40,0	13,0	8,0	120	100	2,1	10192 0
508-06	911666	vz	NO	6,0	47,0	14,5	8,0	180	100	4,3	10193 7
508-07	904890	vz	NO	7,0	53,5	16,0	10,0	320	50	4,9	10194 4
508-08	909588	vz	NO	8,0	58,0	17,0	11,0	420	50	7,7	10195 4
508-10	900446	vz	NO	10,0	72,0	20,0	14,0	600	25	13,7	10196 8
508-12	908615	vz	NO	12,0	84,0	23,5	14,0	750	10	21,8	10197 5
508-14	933784	vz	NO	14,0	105,0	27,0	16,0	1100	10	36,9	10198 2
508-16	933785	vz	NO	16,0	116,0	29,0	20,0	1450	10	54,7	10199 9



500



501

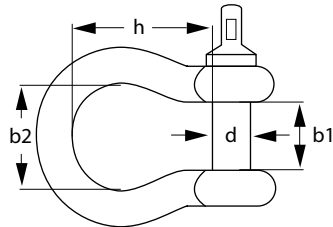
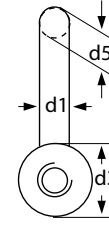
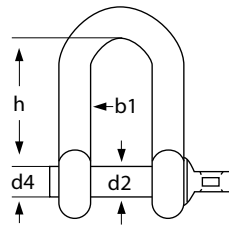

Name	Ident. no.	sur	mat.	d1 mm	d2 mm	d3 mm	b1 mm	b2 mm	h mm	SWL daN	pack. unit	kg per 100 pcs	EAN-no. 4012053
500-05	907134	vz	NO	5,0	5,0	10,0	10,0	-	19,0	80	250	1,5	10040 4
500-06	911336	vz	NO	6,0	6,0	12,0	13,0	-	24,0	100	100	2,5	10041 1
500-08	910878	vz	NO	8,0	8,0	16,0	15,0	-	32,0	200	50	5,5	10042 8
500-10	903303	vz	NO	10,0	10,0	20,0	20,0	-	37,0	320	25	11,1	10043 5
500-11	903628	vz	NO	11,0	11,0	23,0	24,0	-	52,0	520	20	15,5	10044 2
500-13	908602	vz	NO	12,0	12,0	23,0	26,0	-	49,0	520	10	21,6	10045 9
500-14	904688	vz	NO	14,0	14,0	26,0	26,0	-	56,0	600	10	32,4	10046 6
500-16	912667	vz	NO	16,0	16,0	28,0	28,0	-	64,0	800	10	47,1	10047 3
500-19	900855	vz	NO	19,0	19,0	35,0	34,0	-	76,0	1100	5	78,5	10048 0
500-22	901614	vz	NO	22,0	22,0	40,0	40,0	-	80,0	1500	5	132,4	10049 7
500-25	911225	vz	NO	24,0	24,0	47,0	49,0	-	89,0	2100	5	172,8	10030 5
501-05	900599	vz	NO	5,0	5,0	11,0	10,0	14,0	20,5	80	250	1,8	10050 3
501-06	908799	vz	NO	6,0	6,0	12,0	14,0	19,0	25,0	100	100	2,6	10051 0
501-08	906060	vz	NO	8,0	7,5	16,0	16,0	24,0	32,0	200	50	5,9	10052 7
501-10	905951	vz	NO	10,0	10,0	19,0	20,0	30,0	40,0	320	25	11,5	10053 4
501-11	914247	vz	NO	11,0	11,0	22,0	22,0	33,0	45,0	520	20	15,5	10054 1
501-13	911599	vz	NO	12,0	12,0	23,0	26,0	37,0	50,0	520	10	21,0	10055 8
501-14	906407	vz	NO	13,0	14,0	26,0	28,0	45,0	58,0	600	10	34,2	10056 5
501-16	911522	vz	NO	16,0	16,0	30,5	32,0	48,0	60,0	800	10	49,6	10057 2
501-19	906186	vz	NO	19,0	19,0	38,0	36,0	59,0	85,0	1100	5	87,6	10058 9
501-22	907103	vz	NO	22,0	22,0	49,0	46,0	73,0	95,0	1500	5	153,9	10059 6
501-25	901969	vz	NO	25,0	25,0	49,0	50,0	73,0	103,0	2100	5	214,1	10120 3



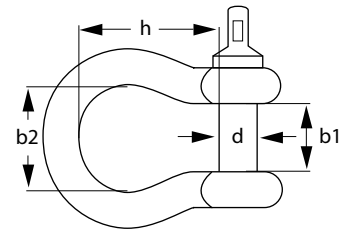

Name	Ident. no.	sur	body mat.	b1 mm	b2 mm	h mm	d mm	SWL daN	pack. unit	kg per 100 pcs	EAN-no. 4012053
500-I-05	902011	po	A4	10,0	-	18,0	5,0	270	50	1,3	10610 9
500-I-06	911063	po	A4	12,0	-	26,0	6,0	385	25	2,3	10611 6
500-I-08	901719	po	A4	15,0	-	28,5	8,0	510	25	5,7	10612 3
500-I-10	900915	po	A4	20,0	-	34,0	10,0	800	20	10,9	10613 0
500-I-12	913031	po	A4	24,0	-	42,0	12,0	1000	10	19,2	10614 7
500-I-16	933828	po	A4	32,0	-	65,0	16,0	1350	5	44,4	10615 4
501-I-05	901410	po	A4	11,0	17,0	22,0	5,0	270	50	1,6	10620 8
501-I-06	904000	po	A4	12,0	21,0	24,0	6,0	385	25	1,9	10621 5
501-I-08	913009	po	A4	17,0	25,0	33,0	8,0	510	25	6,0	10622 2
501-I-10	914759	po	A4	20,0	34,0	38,0	10,0	800	20	12,5	10623 9
501-I-12	904717	po	A4	24,0	38,0	46,0	12,0	1000	10	21,8	10624 6
501-I-16	933829	po	A4	31,0	46,0	56,0	16,0	1350	5	47,1	10625 3

Name	Ident. no.	sur	body mat.	b1 mm	b2 mm	h mm	d mm	BS daN	pack. unit	kg per 100 pcs	EAN-no. 4012053
601-I-04	900258	po	A2	10,0	9,5	15,0	4,0	500	50	0,5	10790 8
603-I-05	903623	po	A2	12,0	11,0	17,0	5,0	1000	50	1,0	10791 5
605-I-05	907733	po	A2	16,0	14,7	24,0	5,0	1000	50	1,6	10792 2
607-I-06	910183	po	A2	14,0	16,0	23,0	6,0	2000	50	2,5	10793 9
611-I-08	913021	po	A2	17,0	19,0	31,0	8,0	3000	25	4,5	10794 6
612-I-10	909612	po	A2	21,0	25,0	40,0	10,0	4800	25	8,5	10795 3
613-I-12	914523	po	A2	25,0	28,5	50,0	12,0	7000	10	16,0	10796 0





82101-A



82101-C

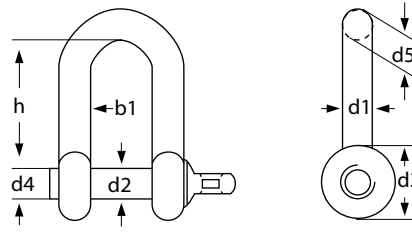

Name	Ident. no.	sur	mat.	Nom. size	d1 mm	d2 mm	d3 mm	d4 mm	d5 mm	b1 mm	h mm	SWL daN	pack. unit	kg per 100 pcs	EAN-no. 4012053
<b>DIN 82101 A</b>															
82101-A	906783	vz	NO	0,10	5,0	5,0	10,0	M 5	5,0	7,0	15,5	100	200	1,5	10370 2
82101-A	905516	vz	NO	0,16	5,0	6,0	12,0	M 6	6,0	8,0	18,0	160	200	2,4	10371 9
82101-A	912630	vz	NO	0,25	7,0	8,0	16,0	M 8	8,0	11,0	24,0	250	50	4,5	10372 6
82101-A	913075	vz	NO	0,40	8,0	10,0	20,0	M 10	10,0	14,0	30,0	400	25	10,0	10373 3
82101-A	903547	vz	NO	0,60	10,0	12,0	24,0	M 12	12,0	17,0	36,0	630	25	15,5	10374 0
82101-A	914077	vz	NO	1,00	13,0	16,0	32,0	M 16	16,0	21,0	49,0	1000	10	30,0	10375 7
82101-A	911101	vz	NO	1,60	17,0	20,0	40,0	M 20	19,0	27,0	61,0	1600	10	56,0	10376 4
82101-A	904813	vz	NO	2,00	19,0	22,0	44,0	M 22	21,0	30,0	67,0	2000	5	97,0	10377 1
82101-A	915073	vz	NO	2,50	21,0	24,0	48,0	M 24	23,0	33,0	73,0	2500	5	170,2	10378 8
82101-A	911565	vz	NO	3,00	24,0	27,0	54,0	M 27	26,0	38,0	83,5	3150	5	185,3	10379 5
82101-A	910661	vz	NO	4,00	27,0	30,0	60,0	M 30	29,0	42,0	91,0	4000	5	240,0	10380 1
82101-A	908160	vz	NO	5,00	30,0	36,0	72,0	M 36	33,0	47,0	111,0	5000	1	402,6	10381 8
82101-A	907779	vz	NO	6,00	34,0	39,0	78,0	M 39	37,0	53,0	119,5	6300	1	521,6	10382 5
82101-A	933868	vz	NO	8,00	38,0	41,0	90,0	M 45	41,0	60,0	139,5	8000	1	675,0	10383 2
82101-A	933869	vz	NO	10,00	42,0	45,0	96,0	M 48	45,0	66,0	147,0	10000	1	976,0	10384 9

<b>DIN 82101 C</b>															
82101-C	933870	vz	NO	0,10	5,0	5,0	10,0	M 5	5,0	7,0	15,5	100	200	1,5	10390 0
82101-C	933871	vz	NO	0,16	5,0	6,0	12,0	M 6	6,0	8,0	18,0	160	200	2,4	10391 7
82101-C	933872	vz	NO	0,25	7,0	8,0	16,0	M 8	8,0	11,0	24,0	250	50	4,5	10392 4
82101-C	933873	vz	NO	0,40	8,0	10,0	20,0	M 10	10,0	14,0	30,0	400	25	10,0	10393 1
82101-C	933874	vz	NO	0,60	10,0	12,0	24,0	M 12	12,0	17,0	36,0	630	25	15,5	10394 8
82101-C	933875	vz	NO	1,00	13,0	16,0	32,0	M 16	16,0	21,0	49,0	1000	10	0,0	10395 5
82101-C	933876	vz	NO	1,60	17,0	20,0	40,0	M 20	19,0	27,0	61,0	1600	10	56,0	10396 2
82101-C	933877	vz	NO	2,00	19,0	22,0	44,0	M 22	21,0	30,0	67,0	2000	5	97,0	10397 9
82101-C	933878	vz	NO	2,50	21,0	24,0	48,0	M 24	23,0	33,0	73,0	2500	5	170,2	10398 6
82101-C	933879	vz	NO	3,00	24,0	27,0	54,0	M 27	26,0	38,0	83,5	3150	5	185,3	10399 3
82101-C	933880	vz	NO	4,00	27,0	30,0	60,0	M 30	29,0	42,0	91,0	4000	1	240	10400 6
82101-C	933881	vz	NO	5,00	30,0	36,0	72,0	M 36	33,0	47,0	111,0	5000	1	402,6	10401 3
82101-C	933882	vz	NO	6,00	34,0	39,0	78,0	M 39	37,0	53,0	119,5	6300	1	521,6	10402 0
82101-C	933883	vz	NO	8,00	38,0	41,0	90,0	M 45	41,0	60,0	139,5	8000	1	675	10403 7
82101-C	933884	vz	NO	10,00	42,0	45,0	96,0	M 48	45,0	66,0	147,0	10000	1	976	10404 4

Orange Pin®



50000

Orange Pin®



50000-S

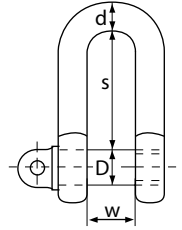

DIN EN 13889:2003  
U.S. Fed. Spec. RR-C-271  
Quality class = 6

Name	Ident. no.	sur	mat.	Nom. size		D mm	W mm	S mm	e mm	SWL t	pack. unit	kg per 100 pcs	EAN-no. 4012053
				mm	inch								
50000-00,33	933701	fe	HS	5,0	"3/16"	6,0	9,0	21,0	14,0	0,33	25	2,2	09730 8
50000-00,50	933702	fe	HS	6,5	"1/4"	8,0	12,0	22,0	17,0	0,50	25	4,5	09731 5
50000-00,75	933703	fe	HS	8,0	"5/16"	9,5	13,5	25,0	18,5	0,75	25	7,2	09732 2
50000-01,00	933704	fe	HS	10,0	"3/8"	11,0	16,5	27,0	22,0	1,00	1	13,5	09733 9
50000-01,50	933705	fe	HS	11,2	"7/16"	12,2	19,0	33,0	25,0	1,50	1	18,5	09734 6
50000-02,00	933706	fe	HS	13,5	"1/2"	16,0	21,5	38,0	29,5	2,00	1	29,5	09735 3
50000-03,25	933707	fe	HS	16,5	"5/8"	19,0	27,0	47,0	38,0	3,25	1	54,0	09736 0
50000-04,75	933708	fe	HS	20,0	"3/4"	22,0	31,5	52,0	44,0	4,75	1	94,0	09737 7
50000-06,50	933709	fe	HS	23,0	"7/8"	25,0	36,5	65,0	50,0	6,50	1	143,0	09738 4
50000-08,50	933710	fe	HS	25,5	"1"	28,0	43,0	74,0	56,0	8,50	1	208,0	09739 1
50000-09,50	933711	fe	HS	29,0	"1 1/8"	32,0	46,5	83,0	64,0	9,50	1	289,4	09740 7
50000-12,00	933712	fe	HS	33,0	"1 1/4"	35,0	51,5	87,0	70,0	12,00	1	410,0	09741 4
50000-13,50	933713	fe	HS	36,5	"1 3/8"	38,0	57,0	104,0	76,0	13,50	1	549,1	09742 1
50000-17,00	933714	fe	HS	39,5	"1 1/2"	42,0	60,0	115,0	84,0	17,00	1	725,0	09743 8
50000-25,00	933715	fe	HS	46,0	"1 3/4"	51,0	74,0	139,0	100,0	25,00	1	1168,1	09744 5
50000-35,00	933716	fe	HS	50,0	"2"	57,0	83,0	171,0	125,0	35,00	1	1778,3	09745 2
50000-S-0,50	933759	fe	HS	6,5	"1/4"	8,0	12,0	22,0	17,0	0,50	25	5,2	09746 9
50000-S-0,75	933760	fe	HS	8,0	"5/16"	9,5	13,5	25,0	18,5	0,75	25	8,7	09747 6
50000-S-1,00	933761	fe	HS	10,0	"3/8"	11,0	16,5	27,0	22,0	1,00	1	14,2	09748 3
50000-S-1,50	933762	fe	HS	11,2	"7/16"	12,2	19,0	33,0	25,0	1,50	1	22,0	09749 0
50000-S-02,00	933717	fe	HS	13,5	"1/2"	16,0	21,5	38,0	29,5	2,00	1	34,5	09750 6
50000-S-03,25	933718	fe	HS	16,5	"5/8"	19,0	27,0	47,0	38,0	3,25	1	61,4	09751 3
50000-S-04,75	933719	fe	HS	20,0	"3/4"	22,0	31,5	52,0	44,0	4,75	1	103,2	09752 0
50000-S-06,50	933720	fe	HS	23,0	"7/8"	25,0	36,5	65,0	50,0	6,50	1	152,0	09753 7
50000-S-08,50	933721	fe	HS	25,5	"1"	28,0	43,0	74,0	56,0	8,50	1	224,0	09754 4
50000-S-09,50	933722	fe	HS	29,0	"1 1/8"	32,0	46,5	83,0	64,0	9,50	1	349,2	09755 1
50000-S-12,00	933723	fe	HS	33,0	"1 1/4"	35,0	51,5	87,0	70,0	12,00	1	457,9	09756 8
50000-S-13,50	933724	fe	HS	36,5	"1 3/8"	38,0	57,0	104,0	76,0	13,50	1	618,9	09757 5
50000-S-17,00	933725	fe	HS	39,5	"1 1/2"	42,0	60,0	115,0	84,0	17,00	1	815,3	09758 2
50000-S-25,00	933726	fe	HS	46,0	"1 3/4"	51,0	74,0	139,0	100,0	25,00	1	1262,5	09759 9
50000-S-35,00	933727	fe	HS	50,0	"2"	57,0	83,0	171,0	125,0	35,00	1	1948,7	09760 5

Orange Pin®

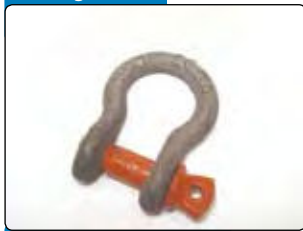

50001

Orange Pin®



50001-S

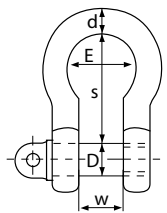

DIN EN 13889:2003  
U.S. Fed. Spec. RR-C-271  
Quality class = 6

Name	Ident. no.	sur	mat.	Nom. size		D mm	W mm	S mm	E mm	SWL t	pack. unit	kg per 100 pcs	EAN-no. 4012053
				mm	inch								
50001-00,33	933728	fe	HS	5,0	"3/16"	6,0	9,0	22,0	17,0	0,33	25	2,1	09660 8
50001-00,50	933729	fe	HS	6,5	"1/4"	8,0	12,0	27,0	19,0	0,50	25	4,8	09661 5
50001-00,75	933730	fe	HS	8,0	"5/16"	9,5	13,5	29,0	20,0	0,75	25	7,8	09662 2
50001-01,00	933731	fe	HS	10,0	"3/8"	11,0	16,5	32,0	24,0	1,00	1	13,6	09663 9
50001-01,50	933732	fe	HS	11,2	"7/16"	12,2	19,0	39,0	27,0	1,50	1	19,7	09664 6
50001-02,00	933733	fe	HS	13,5	"1/2"	16,0	21,5	44,0	30,0	2,00	1	31,0	09665 3
50001-03,25	933734	fe	HS	16,5	"5/8"	19,0	27,0	57,0	39,0	3,25	1	58,8	09666 0
50001-04,75	933735	fe	HS	20,0	"3/4"	22,0	31,5	65,0	48,0	4,75	1	102,5	09667 7
50001-06,50	933736	fe	HS	23,0	"7/8"	25,0	36,5	76,0	55,0	6,50	1	152,0	09668 4
50001-08,50	933737	fe	HS	25,5	"1"	28,0	43,0	88,0	64,0	8,50	1	218,5	09669 1
50001-09,50	933738	fe	HS	29,0	"1 1/8"	32,0	46,5	101,0	70,0	9,50	1	312,0	09670 7
50001-12,00	933739	fe	HS	33,0	"1 1/4"	35,0	51,5	108,0	78,0	12,00	1	458,0	09671 4
50001-13,50	933740	fe	HS	36,5	"1 3/8"	38,0	57,0	126,0	85,0	13,50	1	549,1	09672 1
50001-17,00	933741	fe	HS	39,5	"1 1/2"	42,0	60,0	139,0	94,0	17,00	1	725,0	09673 8
50001-25,00	933742	fe	HS	46,0	"1 3/4"	51,0	74,0	168,0	119,0	25,00	1	1168,1	09674 5
50001-35,00	933743	fe	HS	50,0	"2"	57,0	83,0	171,0	145,0	35,00	1	1778,3	09675 2
50001-S-00,50	933744	fe	HS	6,5	"1/4"	8,0	12,0	27,0	19,0	0,50	25	5,8	09680 6
50001-S-00,75	933745	fe	HS	8,0	"5/16"	9,5	13,5	29,0	20,0	0,75	25	9,5	09681 3
50001-S-01,00	933746	fe	HS	10,0	"3/8"	11,0	16,5	32,0	24,0	1,00	1	15,2	09682 0
50001-S-01,50	933747	fe	HS	11,2	"7/16"	12,2	19,0	39,0	27,0	1,50	1	23,0	09683 7
50001-S-02,00	933748	fe	HS	13,5	"1/2"	16,0	21,5	44,0	30,0	2,00	1	36,0	09684 4
50001-S-03,25	933749	fe	HS	16,5	"5/8"	19,0	27,0	57,0	39,0	3,25	1	66,3	09685 1
50001-S-04,75	933750	fe	HS	20,0	"3/4"	22,0	31,5	65,0	48,0	4,75	1	108,5	09686 8
50001-S-06,50	933751	fe	HS	23,0	"7/8"	25,0	36,5	76,0	55,0	6,50	1	166,0	09687 5
50001-S-08,50	933752	fe	HS	25,5	"1"	28,0	43,0	88,0	64,0	8,50	1	242,0	09688 2
50001-S-09,50	933753	fe	HS	29,0	"1 1/8"	32,0	46,5	101,0	70,0	9,50	1	349,2	09689 9
50001-S-12,00	933754	fe	HS	33,0	"1 1/4"	35,0	51,5	108,0	78,0	12,00	1	457,9	09690 5
50001-S-13,50	933755	fe	HS	36,5	"1 3/8"	38,0	57,0	126,0	85,0	13,50	1	618,9	09691 2
50001-S-17,00	933756	fe	HS	39,5	"1 1/2"	42,0	60,0	139,0	94,0	17,00	1	815,3	09692 9
50001-S-25,00	933757	fe	HS	46,0	"1 3/4"	51,0	74,0	168,0	119,0	25,00	1	1262,5	09693 6
50001-S-35,00	933758	fe	HS	50,0	"2"	57,0	83,0	171,0	145,0	35,00	1	1948,7	09694 3



502



503



504



505

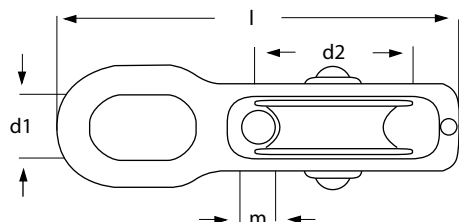

Name	Ident. no.	sur	body mat.	Rope-Ø mm	d2 mm	d1 mm	l mm	BS daN	pack. unit	kg per 100 pcs	EAN-no. 4012053
502-15	929937	vz	ZD	5,0	15,0	10,0	50,0	400	100	2,3	10220 0
502-20	929938	vz	ZD	6,0	20,0	11,0	60,0	450	50	3,8	10221 7
502-25	929939	vz	ZD	7,0	25,0	12,0	70,0	800	25	5,4	10222 4
502-30	929940	vz	ZD	8,0	30,0	13,0	80,0	900	20	7,5	10223 1
502-40	929941	vz	ZD	10,0	40,0	14,0	93,0	1200	20	13,0	10224 8
502-50	929942	vz	ZD	12,0	50,0	16,0	113,0	1500	10	18,9	10225 5
503-30	931110	vz	ZD	8,0	30,0	14,0	103,5	900	25	10,5	10470 9
504-15	931122	vz	ZD	5,0	15,0	10,0	50,0	500	50	3,6	10230 9
504-20	931123	vz	ZD	6,0	20,0	11,0	60,0	800	50	5,9	10231 6
504-25	931124	vz	ZD	7,0	25,0	12,0	70,0	900	25	8,4	10232 3
504-30	931125	vz	ZD	8,0	30,0	13,0	80,0	1000	25	12,1	10233 0
504-40	931126	vz	ZD	10,0	40,0	14,0	93,0	1200	10	20,5	10234 7
504-50	931127	vz	ZD	12,0	50,0	16,0	112,0	1500	5	30,2	10235 4
505-15	931128	vz	ZD	5,0	15,0	13,0	57,0	150	100	2,8	10250 7
505-20	931129	vz	ZD	6,0	20,0	16,0	69,0	200	50	4,3	10251 4
505-25	931130	vz	ZD	7,0	25,0	16,0	74,0	300	25	5,6	10252 1
505-30	931131	vz	ZD	8,5	30,0	18,0	84,0	350	20	7,7	10253 8
505-40	931132	vz	ZD	10,0	40,0	22,0	99,0	400	20	13,1	10254 5
505-50	931133	vz	ZD	12,0	50,0	25,5	118,0	450	10	21,0	10255 2

# Wire Rope Clip



1142



510

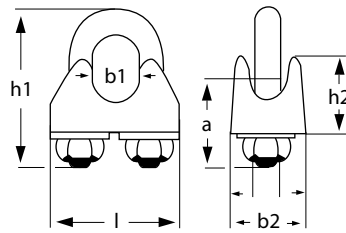

Name	Ident. no.	sur	body mat.	Rope-Ø mm	b1 mm	l mm	d mm	b2 mm	h1 mm	h2 mm	pack. unit	kg per 100 pcs	EAN-no. 4012053
<b>DIN 1142</b>													
1142-05	927924	vz	TG	3/16	8,0	25,0	M 5	13,0	25,0	13,0	200	2,3	10130 2
1142-06	927925	vz	TG	1/4	10,0	30,0	M 6	16,0	32,0	14,0	100	3,8	10131 9
1142-08	928653	vz	TG	5/16	12,0	39,0	M 8	20,0	41,0	18,0	50	8,4	10132 6
1142-10	927927	vz	TG	3/8	13,0	40,0	M 8	20,0	46,0	21,0	25	9,5	10133 3
1142-12	927928	vz	TG	1/2	17,0	54,0	M 12	28,0	64,0	29,0	25	26,0	10134 0
1142-16	927929	vz	TG	5/8	20,0	63,0	M 14	32,0	78,0	34,0	10	43,0	10135 7
1142-19	927930	vz	TG	3/4	23,0	68,0	M 14	32,0	85,0	40,0	10	45,0	10136 4
1142-22	927931	vz	TG	7/8	25,0	74,0	M 16	34,0	96,0	44,0	5	62,8	10137 1
1142-25	930382	vz	TG	1	28,0	84,0	M 20	38,0	114,0	49,0	5	118,3	10138 8
1142-30	931908	vz	TG	1 1/8	36,0	95,0	M 20	41,0	127,0	59,0	1	141,7	10139 5
1142-34	931907	vz	TG	1 1/4	37,0	105,0	M 22	45,0	150,0	67,0	1	200,5	10140 1
1142-40	931909	vz	TG	1 1/2	47,0	117,0	M 24	49,0	159,0	77,0	1	268,0	10141 8
<b>DIN 741</b>													
510-03	901503	vz	TG	1/8	5,0	20,0	M 4	11,0	20,0	10,0	300	0,8	10010 7
510-05	903824	vz	TG	3/16	6,0	22,0	M 5	12,0	23,0	10,0	250	1,2	10011 4
510-06	913631	vz	TG	1/4	9,0	25,0	M 5	12,0	28,0	11,0	200	1,7	10012 1
510-08	914196	vz	TG	5/16	10,0	29,0	M 6	14,0	34,0	15,0	100	3,2	10013 8
510-10	907363	vz	TG	3/8	11,0	33,0	M 8	18,0	43,0	17,0	50	6,5	10014 5
510-11	904147	vz	TG	7/16	14,0	35,0	M 8	19,0	43,0	18,0	50	6,7	10015 2
510-13	908483	vz	TG	1/2	15,0	42,0	M 10	23,0	54,0	21,0	25	12,3	10016 9
510-14	913320	vz	TG	9/16	16,0	42,0	M 10	23,0	56,0	23,0	25	12,7	10017 6
510-16	914307	vz	TG	5/8	18,0	48,0	M 12	26,0	62,0	26,0	20	18,5	10018 3
510-19	904346	vz	TG	3/4	22,0	54,0	M 12	29,0	71,0	30,0	10	24,3	10019 0
510-22	910126	vz	TG	7/8	24,0	60,0	M 14	33,0	86,0	34,0	10	30,6	10020 6
510-25	914862	vz	TG	1	28,0	63,0	M 14	34,0	96,0	36,0	10	44,9	10021 3
510-30	917027	vz	TG	1 1/8	33,0	74,0	M 16	37,0	110,0	42,0	5	61,6	10022 0
510-34	906281	vz	TG	1 1/4	38,0	80,0	M 15	41,0	122,0	50,0	1	62,7	10023 7
510-40	917028	vz	TG	1 1/2	44,0	89,0	M 16	44,0	142,0	56,0	1	97,0	10024 4

## INOX

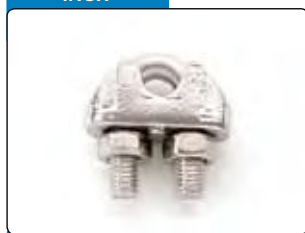

515-I

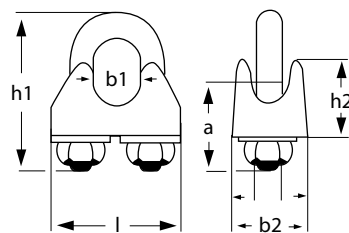

Name	Ident. no.	sur	body mat.	Rope-Ø mm	l mm	d mm	b1 mm	b2 mm	h1 mm	h2 mm	pack. unit	kg per 100 pcs	EAN-no. 4012053
515-I-02	933826	po	A4	2	17,0	3,0	5,0	8,5	18,0	10,0	100	0,9	10778 6
515-I-03	924714	po	A4	3	20,0	4,0	5,0	10,0	20,0	10,0	100	1,1	10770 0
515-I-04	919880	po	A4	4	20,0	4,0	5,0	10,0	22,0	10,0	100	1,6	10771 7
515-I-05	919881	po	A4	5	24,0	5,0	7,0	11,0	24,0	11,0	50	1,8	10772 4
515-I-06	919882	po	A4	6	26,0	5,0	9,0	12,0	29,0	11,0	50	2,1	10773 1
515-I-08	919883	po	A4	8	32,5	6,0	10,0	14,0	35,0	15,0	25	4,3	10774 8
515-I-10	919884	po	A4	10	33,0	7,0	12,0	16,0	42,0	17,0	20	6,8	10775 5
515-I-12	919885	po	A4	12	37,0	8,0	12,0	20,0	45,0	19,0	10	18,0	10776 2
515-I-14	919886	po	A4	14	44,0	10,0	16,0	23,0	58,0	22,0	10	28,0	10777 9



511



512



514

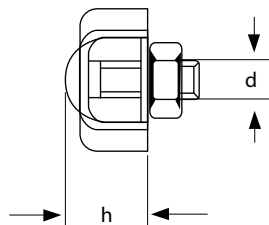
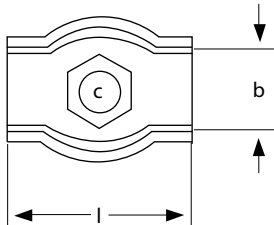

Name	Ident. no.	sur	body mat.	Rope-Ø mm	b mm	l mm	h mm	d mm	pack. unit	kg per 100 pcs	EAN-no. 4012053
511-02	917834	vz	NO	2,0	5,0	17,0	6,0	M 4	200	0,7	10060 2
511-03	917835	vz	NO	3,0	7,0	18,0	7,0	M 4	200	0,8	10061 9
511-04	917836	vz	NO	4,0	9,0	22,0	9,0	M 5	200	1,0	10062 6
511-05	917837	vz	NO	5,0	11,0	26,0	11,0	M 5	100	1,4	10063 3
511-06	917838	vz	NO	6,0	13,0	30,0	11,0	M 6	50	2,2	10064 0
511-08	933821	vz	NO	8,0	18,0	28,0	14,0	M 8	50	5,0	10065 7
511-10	933822	vz	NO	10,0	21,5	42,0	19,0	M 10	25	5,4	10066 4
512-02	933823	vz	NO	2,0	5,5	35,0	6,0	M 4	100	0,9	10074 9
512-03	905253	vz	NO	3,0	7,0	35,0	6,5	M 4	100	1,5	10070 1
512-04	901422	vz	NO	4,0	9,0	40,0	7,5	M 5	100	2,2	10071 8
512-05	912533	vz	NO	5,0	11,0	51,0	8,5	M 5	50	3,8	10072 5
512-06	903161	vz	NO	6,0	13,0	60,0	11,0	M 6	25	5,5	10073 2
512-08	933824	vz	NO	8,0	18,0	75,0	14,0	M 8	25	10,0	10075 6
512-10	933825	vz	NO	10,0	21,5	84,0	20,0	M 10	20	18,0	10076 3
514-02	927933	vz	NO	2,0	11,0	28,0	10,0	M 5	100	2,1	10090 9
514-03	927934	vz	NO	3,0	11,5	28,0	10,0	M 5	100	3,0	10091 6
514-04	927935	vz	NO	4,0	15,0	34,0	15,0	M 6	100	4,1	10092 3
514-05	933819	vz	NO	5,0	16,0	34,0	15,0	M 6	100	4,2	10093 0
514-06	933820	vz	NO	6,0	20,0	35,0	15,0	M 6	50	5,0	10094 7

# Wire Rope Clip

INOX



511-I

INOX



512-I

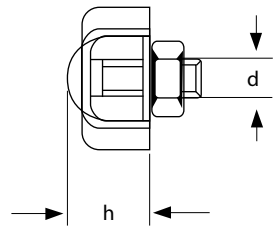
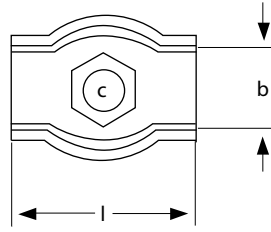

Name	Ident. no.	sur	body mat.	Rope-Ø mm	b mm	d mm	h mm	l mm	pack. unit	kg per 100 pcs	EAN-no. 4012053
511-I-02	924822	po	A2	2	4,0	M 4,0	5,0	15,0	200	0,5	10750 2
511-I-03	924823	po	A2	3	6,0	M 4,0	7,0	17,0	100	0,6	10751 9
511-I-04	924824	po	A2	4	8,0	M 5,0	7,0	20,0	100	1,1	10752 6
511-I-05	924825	po	A2	5	10,0	M 5,0	8,0	25,0	50	1,4	10753 3
511-I-06	924826	po	A2	6	13,0	M 6,0	10,0	30,0	50	2,8	10754 0
511-I-08	950016	po	A2	8	18,0	M 8,0	12,0	38,0	25	4,8	10755 7
511-I-10	933827	po	A2	10	21,5	M 10,0	15,0	42,0	25	5,0	10756 4
512-I-02	924827	po	A2	2	4,0	M 4,0	6,0	30,0	100	1,0	10760 1
512-I-03	924828	po	A2	3	7,0	M 4,0	7,0	35,0	50	1,3	10761 8
512-I-04	924829	po	A2	4	8,0	M 5,0	7,5	40,0	50	2,3	10762 5
512-I-05	924830	po	A2	5	10,0	M 5,0	10,0	50,0	50	2,8	10763 2
512-I-06	924831	po	A2	6	12,0	M 6,0	12,0	60,0	25	5,5	10764 9
512-I-08	924832	po	A2	8	18,0	M 8,0	15,0	72,0	20	9,6	10765 6
512-I-10	924833	po	A2	10	21,0	M 10,0	16,0	94,5	10	19,5	10766 3







1390-A



1390-B



1390-C

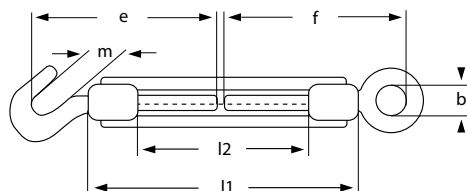

Name	Ident. no.	sur	mat.	l1 mm	l2 mm	b mm	e mm	f mm	m mm	pack. unit	kg per 100 pcs	EAN-no. 4012053
1390-M05-050 A	903186	vz	ZD	50	30	8	44	44	7	100	3,3	10110 4
1390-M05-070 A	915100	vz	ZD	70	50	9	55	54	7	100	3,6	10111 1
1390-M06-060 A	904560	vz	ZD	60	35	10	55	54	9	100	4,9	10112 8
1390-M06-100 A	914671	vz	ZD	100	72	10	78	74	9	50	6,7	10113 5
1390-M08-070 A	903662	vz	ZD	70	43	10	59	59	10	50	8,5	10114 2
1390-M08-110 A	914724	vz	ZD	110	80	10	80	80	11	25	11,6	10115 9
1390-M10-080 A	903725	vz	ZD	80	50	13	66	60	11	20	14,7	10116 6
1390-M10-120 A	904201	vz	ZD	120	90	13	89	87	13	1	18,2	10117 3
1390-M12-130 A	921148	vz	ZD	130	90	24	116	112	26	1	38,7	10119 7
1390-M05-050 B	900789	vz	ZD	50	30	8	40	40	-	100	3,4	10320 7
1390-M05-070 B	910291	vz	ZD	70	50	9	50	50	-	100	3,8	10321 4
1390-M06-060 B	913783	vz	ZD	60	35	10	50	50	-	100	5,1	10322 1
1390-M06-100 B	901950	vz	ZD	100	72	10	69	69	-	50	7,1	10323 8
1390-M08-070 B	909345	vz	ZD	70	43	10	59	59	-	50	8,7	10324 5
1390-M08-110 B	916933	vz	ZD	110	80	10	80	80	-	25	11,7	10325 2
1390-M10-080 B	909411	vz	ZD	80	50	13	66	66	-	20	16,0	10326 9
1390-M10-120 B	921144	vz	ZD	120	90	13	87	87	-	1	18,6	10329 6
1390-M12-130 B	921149	vz	ZD	130	90	24	116	112	-	1	39,3	10328 3
1390-M05-050 C	905060	vz	ZD	50	30	-	40	40	7	100	3,3	10330 6
1390-M05-070 C	900134	vz	ZD	70	50	-	50	50	8	100	3,6	10331 3
1390-M06-060 C	909066	vz	ZD	60	35	-	52	52	8	100	4,9	10332 0
1390-M06-100 C	907861	vz	ZD	100	72	-	70	70	9	50	6,9	10333 7
1390-M08-070 C	905593	vz	ZD	70	43	-	60	60	10	50	8,4	10334 4
1390-M08-110 C	916924	vz	ZD	110	80	-	80	80	10	25	12,8	10335 1
1390-M10-080 C	905662	vz	ZD	80	50	-	66	66	11	20	15,6	10336 8
1390-M10-120 C	921145	vz	ZD	120	80	-	92	92	11	1	24,4	10337 5
1390-M12-130 C	921150	vz	ZD	130	90	-	116	120	24	1	38,0	10338 2

# Turnbuckle DIN 1480



1480-A



1480-B



1480-C

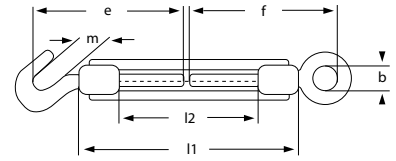

Name	Ident. no.	sur	mat.	l1 mm	l2 mm	b mm	e mm	f mm	m mm	pack. unit	kg per 100 pcs	EAN-no. 4012053
<b>DIN 1480</b>												
1480-M06-110 A	912288	vz	NO	110,0	86,0	8,0	84,0	73,0	8,0	25	9,0	10100 5
1480-M08-110 A	914391	vz	NO	110,0	80,0	11,0	78,0	78,0	10,0	25	13,5	10101 2
1480-M10-125 A	903001	vz	NO	125,0	80,0	14,0	95,0	95,0	12,0	10	22,8	10102 9
1480-M12-125 A	911277	vz	NO	125,0	85,0	16,0	104,0	100,0	15,0	10	35,8	10103 6
1480-M14-140 A	912395	vz	NO	140,0	93,0	18,0	110,0	110,0	15,0	10	52,7	10104 3
1480-M16-170 A	911331	vz	NO	170,0	118,0	22,0	130,0	130,0	18,0	10	92,0	10105 0
1480-M20-200 A	912467	vz	NO	200,0	130,0	24,0	165,0	160,0	22,0	10	153,0	10106 7
1480-M22-220 A	917857	vz	NO	220,0	150,0	27,0	190,0	170,0	25,0	10	224,0	10107 4
1480-M24-255 A	913331	vz	NO	250,0	175,0	28,0	195,0	185,0	29,0	1	262,0	10108 1
1480-M30-255 A	933855	vz	NO	255,0	165,0	30,0	235,0	240,0	33,0	1	492,6	10109 8
1480-M36-295 A	934642	vz	NO	295,0	190,0	38,0	280,0	260,0	44,0	1	858,6	10920 9
1480-M06-110 B	919324	vz	NO	110,0	86,0	8,0	73,0	73,0	-	25	8,9	10340 5
1480-M08-110 B	917851	vz	NO	110,0	80,0	11,0	72,0	72,0	-	25	13,1	10341 2
1480-M10-125 B	905044	vz	NO	125,0	90,0	14,0	88,0	85,0	-	10	23,4	10342 9
1480-M12-125 B	915484	vz	NO	125,0	85,0	16,0	96,0	96,0	-	10	34,6	10343 6
1480-M14-140 B	908603	vz	NO	140,0	93,0	18,0	110,0	110,0	-	10	50,9	10344 3
1480-M16-170 B	900045	vz	NO	170,0	118,0	22,0	140,0	140,0	-	10	89,8	10345 0
1480-M20-200 B	908652	vz	NO	200,0	136,0	23,0	150,0	150,0	-	10	149,0	10346 7
1480-M22-220 B	917858	vz	NO	220,0	150,0	27,0	175,0	175,0	-	10	188,0	10347 4
1480-M24-255 B	917859	vz	NO	255,0	175,0	32,0	195,0	195,0	-	1	277,0	10348 1
1480-M30-255 B	933856	vz	NO	255,0	165,0	30,0	235,0	240,0	-	1	445,4	10349 8
1480-M36-295 B	934643	vz	NO	295,0	185,0	38,0	255,0	255,0	-	1	768,0	10930 8
1480-M06-110 C	919325	vz	NO	110,0	86,0	-	87,0	87,0	8,0	25	10,4	10350 4
1480-M08-110 C	905352	vz	NO	110,0	80,0	-	90,0	90,0	10,0	25	16,7	10351 1
1480-M10-125 C	917852	vz	NO	125,0	86,0	-	85,0	87,0	11,0	10	26,1	10352 8
1480-M12-125 C	919323	vz	NO	125,0	85,0	-	110,0	110,0	15,0	10	44,5	10353 5
1480-M14-140 C	917854	vz	NO	140,0	93,0	-	110,0	110,0	15,0	10	58,2	10354 2
1480-M16-170 C	909746	vz	NO	170,0	118,0	-	130,0	127,0	15,0	10	85,3	10355 9
1480-M20-200 C	917856	vz	NO	200,0	136,0	-	160,0	160,0	20,0	10	152,0	10356 6
1480-M22-220 C	926599	vz	NO	220,0	150,0	-	175,0	170,0	24,0	10	195,0	10357 3
1480-M24-255 C	917860	vz	NO	255,0	175,0	-	235,0	235,0	26,0	1	349,8	10358 0
1480-M30-255 C	933857	vz	NO	255,0	165,0	-	240,0	240,0	33,0	1	534,4	10359 7
1480-M36-295 C	934644	vz	NO	295,0	185,0	-	280,0	275,0	40,0	1	934,5	10940 7



**1480 AE**

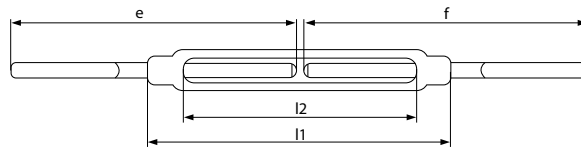

Name	Ident. no.	sur	body mat.	l1 mm	l2 mm	e mm	f mm	pack. unit	kg per 100 pcs	EAN-no. 4012053
1480-M06-110 AE	928598	bl	NO	110,0	85,0	120,0	120,0	50	9,5	10360 3
1480-M08-110 AE	921151	bl	NO	110,0	78,0	121,0	121,0	50	15,0	10361 0
1480-M10-125 AE	921152	bl	NO	125,0	87,0	150,0	150,0	25	29,2	10362 7
1480-M12-125 AE	921153	bl	NO	125,0	81,0	147,0	147,0	10	44,0	10363 4
1480-M14-140 AE	921154	bl	NO	140,0	94,0	181,0	181,0	10	61,0	10364 1
1480-M16-170 AE	921155	bl	NO	170,0	113,0	198,0	198,0	1	92,3	10365 8
1480-M20-200 AE	921156	bl	NO	200,0	135,0	220,0	220,0	1	168,3	10366 5
1480-M22-220 AE	927999	bl	NO	220,0	150,0	240,0	240,0	1	199,7	10367 2
1480-M24-255 AE	921158	bl	NO	255,0	180,0	220,0	220,0	1	293,4	10368 9



**1485-IA**



**1485-IB**



**1485-IC**

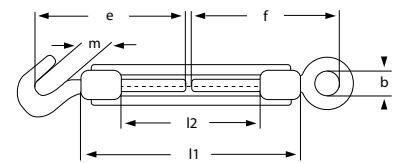

Name	Ident. no.	sur	body mat.	l1 mm	l2 mm	b mm	e mm	f mm	m mm	pack. unit	kg per 100 pcs	EAN-no. 4012053
1485-I-05 A	907736	po	A4	73,0	57,0	8,0	58,0	62,0	6	25	4,4	10820 2
1485-I-06 A	910539	po	A4	100,0	75,0	10,0	74,0	75,0	9	25	8,5	10821 9
1485-I-08 A	909627	po	A4	120,0	92,0	12,0	91,0	85,0	10	10	14,3	10822 6
1485-I-10 A	906215	po	A4	150,0	122,0	14,0	107,0	103,0	11	10	24,0	10823 3
1485-I-12 A	904372	po	A4	200,0	170,0	20,0	145,0	147,0	12	1	52,8	10824 0
1485-I-16 A	906628	po	A4	250,0	210,0	22,0	165,0	177,0	19	1	111,5	10825 7
1485-I-05 B	932306	po	A4	73,0	57,0	8,0	57,0	57,0	-	25	4,7	10810 3
1485-I-06 B	930072	po	A4	100,0	75,0	10,0	76,0	76,0	-	25	8,4	10811 0
1485-I-08 B	930073	po	A4	120,0	93,0	12,0	87,0	87,0	-	10	14,5	10812 7
1485-I-10 B	930074	po	A4	150,0	122,0	14,0	102,0	102,0	-	10	24,4	10813 4
1485-I-12 B	930075	po	A4	200,0	170,0	18,0	137,0	137,0	-	1	53,9	10814 1
1485-I-16 B	930076	po	A4	250,0	215,0	22,0	180,0	180,0	-	1	113,0	10815 8
1485-I-05 C	933623	po	A4	73,0	57,0	-	56,0	56,0	6	25	4,0	10880 6
1485-I-06 C	933624	po	A4	90,0	68,0	-	74,0	74,0	9	25	7,4	10881 3
1485-I-08 C	933625	po	A4	120,0	93,0	-	88,0	88,0	10	10	13,8	10882 0
1485-I-10 C	933626	po	A4	150,0	120,0	-	123,0	123,0	11	10	23,8	10883 7
1485-I-12 C	933627	po	A4	200,0	170,0	-	145,0	145,0	12	1	50,2	10884 4
1485-I-16 C	933628	po	A4	250,0	210,0	-	195,0	195,0	19	1	109,5	10885 1

INOX



4250-I

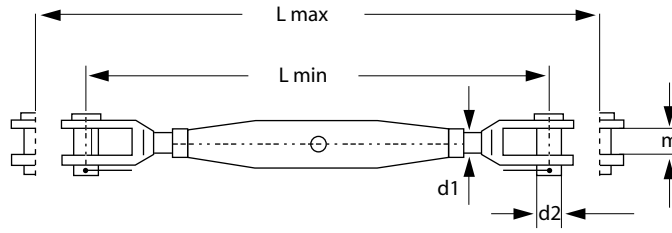

Name	Ident. no.	sur	body mat.	L min mm	L max mm	d1 mm	d2 daN	m daN	BS daN	pack. unit	kg per 100 pcs	EAN-no. 4012053
4250-I-05	914337	po	A4	124	180	M 5	5,0	7,5	700	10	5,1	10660 4
4250-I-06	907744	po	A4	140	200	M 6	5,0	7,5	900	1	9,0	10661 1
4250-I-08	909628	po	A4	166	240	M 8	8,0	10,0	1500	1	15,0	10662 8
4250-I-10	913298	po	A4	176	280	M 10	9,5	10,0	3000	1	26,0	10663 5
4250-I-12	902167	po	A4	222	350	M 12	12,0	10,0	4500	1	52,5	10664 2



89



90

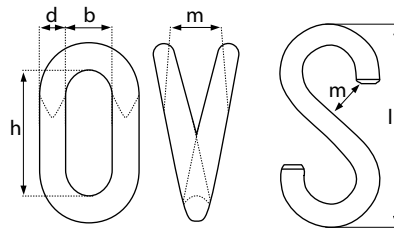

Name	Ident. no.	sur	body mat.	d mm	h/l mm	b mm	m mm	pack. unit	kg per 100 pcs	EAN-no. 4012053
89-03	916404	vz	NO	3,0	18,0	7,0	7,0	500	0,4	10150 0
89-04	916406	vz	NO	4,0	20,0	8,0	12,0	500	0,7	10151 7
89-05	950032	vz	NO	5,0	23,0	11,0	13,0	200	1,7	11529 3
89-06	916410	vz	NO	6,0	26,0	11,0	14,0	50	2,4	10152 4
89-07	950033	vz	NO	7,0	30,0	14,0	17,0	50	4,2	10157 9
89-08	916413	vz	NO	8,0	37,0	19,0	18,0	50	6,3	10153 1
89-09	950034	vz	NO	9,0	37,0	20,0	18,0	25	9,4	10158 6
89-10	916415	vz	NO	10,0	40,0	20,0	22,0	25	10,4	10154 8
90-03	916421	vz	NO	3,0	25,0	-	3,5	500	0,4	10160 9
90-04	916422	vz	NO	4,0	35,0	-	5,0	500	0,7	10161 6
90-05	916425	vz	NO	5,0	45,5	-	7,0	200	1,4	10162 3
90-06	916416	vz	NO	6,0	55,0	-	7,0	100	2,9	10163 0
90-07	950035	vz	NO	7,0	65,0	-	8,0	50	4,0	10166 1
90-08	916418	vz	NO	8,0	81,0	-	10,0	50	6,9	10164 7
90-10	916420	vz	NO	10,0	105,0	-	12,0	25	12,1	10165 4



840

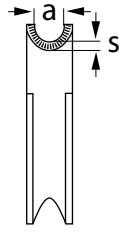
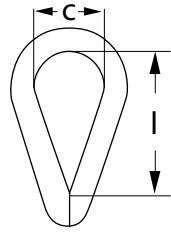

Name	Ident. no.	sur	body mat.	Rope-Ø mm	a mm	c mm	l mm	s mm	pack. unit	kg per 100 pcs	EAN-no. 4012053
<b>DIN 6899-B</b>											
840-03	902745	vz	NO	2,5	3,0	12,0	20,0	1,4	500	0,6	10080 8
840-04	900349	vz	NO	3,5	4,0	13,0	21,5	1,4	250	0,7	10081 7
840-05	901726	vz	NO	4,0	5,0	13,0	23,0	1,7	200	1,2	10082 4
840-06	911489	vz	NO	5,0	6,0	16,0	24,5	1,7	100	2,5	10083 1
840-08	907480	vz	NO	7,0	8,0	19,0	31,0	2,2	100	2,7	10084 8
840-10	911136	vz	NO	9,0	10,0	24,0	38,0	3,1	50	5,1	10085 5
840-12	903530	vz	NO	11,0	12,0	25,0	49,0	3,7	25	6,9	10086 2
840-14	910038	vz	NO	13,0	14,0	31,0	50,0	3,7	25	8,4	10087 9
840-16	901302	vz	NO	15,0	16,0	37,0	59,0	3,7	20	19,4	10088 6
840-18	908894	vz	NO	16,0	18,0	38,0	67,0	3,8	10	24,1	10089 3
840-20	903838	vz	NO	18,0	20,0	39,0	67,0	3,8	10	29,0	10095 4
840-22	900955	vz	NO	20,0	22,0	45,0	70,0	4,6	10	55,6	10096 1
840-24	901641	vz	NO	22,0	24,0	56,0	91,0	4,2	5	57,2	10097 8
840-26	915201	vz	NO	24,0	26,0	56,0	91,0	4,4	5	63,3	10098 5
840-28	914669	vz	NO	26,0	28,0	61,0	100,0	8,0	5	110,0	10099 2



# Thimble / Ring

INOX



844-I

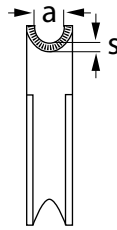
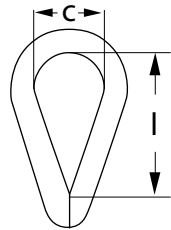

Name	Ident. no.	sur	body mat.	Rope-Ø mm	a mm	c mm	l mm	s mm	pack. unit	kg per 100 pcs	EAN-no. 4012053
844-I-02	924715	po	A2	2,0	2,0	6,5	14,0	1,0	200	0,15	10880 4
844-I-03	924716	po	A2	2,5	3,0	9,0	16,0	1,0	100	0,2	10801 1
844-I-04	924717	po	A2	3,5	4,0	11,0	17,5	1,0	100	0,3	10802 8
844-I-05	924718	po	A2	4,0	5,0	13,0	21,0	1,1	100	0,6	10803 5
844-I-06	924719	po	A2	5,0	7,0	14,0	24,0	1,2	50	1,0	10804 2
844-I-08	924720	po	A2	7,0	8,0	18,0	34,0	1,5	50	1,8	10805 9
844-I-10	924721	po	A2	9,0	11,0	23,0	42,0	1,9	50	2,7	10806 6
844-I-12	924722	po	A2	11,0	13,5	30,0	48,0	1,9	25	3,8	10807 3
844-I-14	924723	po	A2	13,0	16,0	32,0	52,0	1,9	20	6,3	10808 0
844-I-16	924724	po	A2	15,0	16,0	38,0	60,0	2,0	10	10,8	10809 7



258-GE

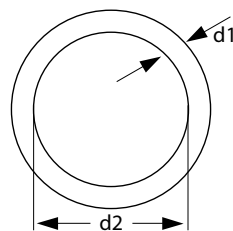

Name	Ident. no.	sur	body mat.	d2 mm	d1 mm	pack. unit	kg per 100 pcs	EAN-no. 4012053
258-35-07	917842	vz	NO	35,0	7,0	100	4,2	10263 7
258-40-05	933919	vz	NO	40,0	5,0	100	2,2	10264 4
258-40-06	917844	vz	NO	40,0	6,0	100	3,3	10265 1
258-40-08	933920	vz	NO	40,0	8,0	50	6,2	10266 8
258-40-09	933921	vz	NO	40,0	9,0	50	7,9	10267 5
258-40-10	933922	vz	NO	40,0	10,0	25	9,6	10268 2
258-45-09	933931	vz	NO	45,0	9,0	50	8,8	10269 9
258-50-05	933923	vz	NO	50,0	5,0	100	2,8	10980 3
258-50-08	933924	vz	NO	50,0	8,0	50	8,9	10981 0
258-50-09	933925	vz	NO	50,0	9,0	25	9,3	10982 7
258-50-10	933589	vz	NO	50,0	10,0	25	11,8	10260 6
258-50-12	933926	vz	NO	50,0	12,0	25	17,4	10983 4
258-60-06	933927	vz	NO	60,0	6,0	100	5,0	10984 1
258-60-08	933928	vz	NO	60,0	8,0	50	10,3	10985 8
258-60-09	933929	vz	NO	60,0	9,0	25	11,1	10986 5
258-60-10	933930	vz	NO	60,0	10,0	20	14,1	10987 2
258-60-12	933590	vz	NO	60,0	12,0	25	20,7	10261 3



258-MS

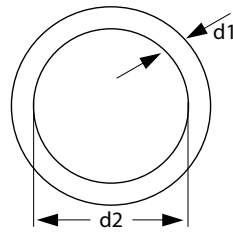

Name	Ident. no.	sur	body mat.	d1 mm	d2 mm	pack. unit	kg per 100 pcs	EAN-no.
258-MS-30-05	900683	bl	MS	5,0	32,0	100	2,3	4012053 11301 5



580



582

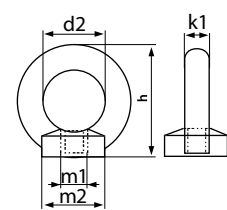
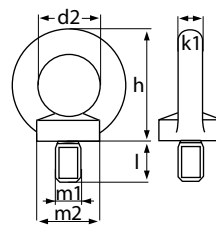

Name	Ident. no.	sur	body mat.	d2 mm	k1 mm	h mm	l mm	m1 mm	m2 mm	SWL daN	pack. unit	kg per 100 pcs	EAN-no.
<b>DIN 580</b>													
580-06	931745	vz	NO	20,0	9,0	37,0	13,0	M 6	20,0	70	50	3,5	10290 3
580-08	931746	vz	NO	20,0	9,0	37,0	13,0	M 8	20,0	140	50	6,2	10291 0
580-10	931747	vz	NO	25,0	10,0	45,0	17,0	M 10	25,0	230	25	10,6	10292 7
580-12	931748	vz	NO	30,0	13,0	53,0	20,0	M 12	30,0	340	10	17,0	10293 4
580-14	931749	vz	NO	35,0	14,0	62,0	25,0	M 14	35,0	490	10	22,0	10294 1
580-16	931750	vz	NO	35,0	14,0	62,0	25,0	M 16	35,0	700	10	29,0	10295 8
580-20	931751	vz	NO	40,0	16,0	71,0	30,0	M 20	40,0	1200	10	44,8	10296 5
580-22	933792	vz	NO	45,0	18,0	82,0	35,0	M 22	45,0	1500	5	62,0	10297 2
580-24	933793	vz	NO	50,0	20,0	90,0	36,0	M 24	50,0	1800	5	89,0	10298 9

<b>DIN 582</b>													
582-06	931752	vz	NO	20,0	9,0	37,0	-	M 6	20,0	70	50	3,0	10310 8
582-08	931753	vz	NO	20,0	9,0	37,0	-	M 8	20,0	140	50	4,8	10311 5
582-10	931754	vz	NO	25,0	10,0	45,0	-	M 10	25,0	230	25	9,3	10312 2
582-12	931755	vz	NO	30,0	13,0	53,0	-	M 12	30,0	340	10	15,0	10313 8
582-14	931756	vz	NO	35,0	14,0	62,0	-	M 14	35,0	490	10	19,0	10314 6
582-16	931757	vz	NO	35,0	14,0	62,0	-	M 16	35,0	700	10	22,0	10315 3
582-20	931758	vz	NO	40,0	16,0	71,0	-	M 20	40,0	1200	10	33,0	10316 0
582-22	933794	vz	NO	45,0	18,0	82,0	-	M 22	45,0	1500	5	49,0	10317 7
582-24	933795	vz	NO	50,0	20,0	90,0	-	M 24	50,0	1800	5	71,0	10318 4

INOX



580-I

INOX



582-I

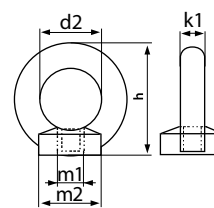
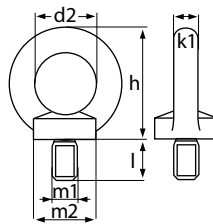

Name	Ident. no.	sur	body mat.	d2 mm	k1 mm	h mm	l mm	m1 mm	m2 daN	SWL daN	pack. unit	kg per 100 pcs	EAN-no. 4012053
<b>DIN 580</b>													
580-I-06	932129	po	A4	15,0	6,0	30,0	13,0	M 6	16,0	90	50	2,4	10700 7
580-I-08	932130	po	A4	19,0	9,0	35,0	13,0	M 8	20,0	140	50	3,3	10701 4
580-I-10	932131	po	A4	25,0	11,0	45,0	15,0	M 10	25,0	230	25	10,0	10702 1
580-I-12	932132	po	A4	28,0	12,0	51,0	22,0	M 12	30,0	340	20	16,2	10703 8
580-I-16	932133	po	A4	35,0	14,0	64,0	30,0	M 16	35,0	700	10	28,0	10704 5
580-I-20	932134	po	A4	40,0	17,0	76,0	38,0	M 20	40,0	1200	10	49,5	10705 2
580-I-24	932135	po	A4	50,0	20,0	96,0	47,0	M 24	50,0	1800	4	90,0	10706 9
580-I-06	933058	po	A2	15,0	6,0	30,0	13,0	M 6	16,0	90	50	2,4	10850 9
580-I-08	933059	po	A2	19,0	9,0	35,0	13,0	M 8	20,0	140	50	3,3	10851 6
580-I-10	933060	po	A2	25,0	11,0	45,0	15,0	M 10	25,0	230	25	10,0	10852 3
580-I-12	933061	po	A2	28,0	12,0	51,0	19,0	M 12	30,0	340	20	16,2	10853 0
580-I-16	933062	po	A2	35,0	14,0	62,0	25,0	M 16	35,0	700	10	28,0	10854 7
580-I-20	933063	po	A2	40,0	16,0	75,0	38,0	M 20	40,0	1200	10	49,5	10855 4
580-I-24	933064	po	A2	48,0	20,0	92,0	36,0	M 24	50,0	1800	4	90,0	10856 1
<b>DIN 582</b>													
582-I-06	932136	po	A4	15,0	6,0	28,0	-	M 6	16,0	90	50	2,0	10740 3
582-I-08	932137	po	A4	19,0	9,0	35,0	-	M 8	20,0	140	50	3,0	10741 0
582-I-10	932138	po	A4	25,0	11,0	45,0	-	M 10	25,0	230	25	7,2	10742 7
582-I-12	932139	po	A4	28,0	12,0	53,0	-	M 12	30,0	340	20	13,4	10743 4
582-I-16	932140	po	A4	35,0	14,0	62,0	-	M 16	35,0	700	10	22,0	10744 1
582-I-20	932141	po	A4	40,0	16,0	75,0	-	M 20	40,0	1200	10	36,0	10745 8
582-I-24	932142	po	A4	48,0	20,0	92,0	-	M 24	50,0	1800	4	71,0	10746 5
582-I-06	933065	po	A2	15,0	6,0	28,0	-	M 6	16,0	90	50	2,0	10860 8
582-I-08	933066	po	A2	19,0	9,0	35,0	-	M 8	20,0	140	50	3,0	10861 5
582-I-10	933067	po	A2	25,0	11,0	45,0	-	M 10	25,0	230	25	7,2	10862 2
582-I-12	933068	po	A2	28,0	12,0	53,0	-	M 12	30,0	340	20	13,4	10863 9
582-I-16	933069	po	A2	35,0	14,0	62,0	-	M 16	35,0	700	10	22,0	10864 6
582-I-20	933070	po	A2	40,0	16,0	75,0	-	M 20	40,0	1200	10	36,0	10865 3
582-I-24	933071	po	A2	48,0	20,0	92,0	-	M 24	50,0	1800	4	71,0	10866 0





60000

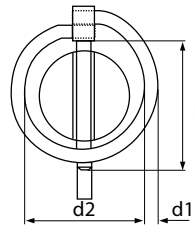

Name	Ident. no.	sur	body mat.	d mm	d1 mm	d2 mm	l mm	pack. unit	kg per 100 pcs	EAN-no. 4012053
60000-04	932689	vz	NO	4,0	3,4	34,0	42,0	100	2,0	09520 5
60000-06	932690	vz	NO	6,0	3,4	41,0	42,0	50	2,8	09521 2
60000-08	932692	vz	NO	8,0	3,4	41,0	42,0	50	3,5	09523 6
60000-09	932693	vz	NO	9,0	3,4	41,0	42,0	50	3,8	09524 3
60000-10	932694	vz	NO	10,0	3,4	41,0	42,0	50	4,4	09525 0
60000-11	932695	vz	NO	11,0	3,4	41,0	42,0	50	4,6	09526 7

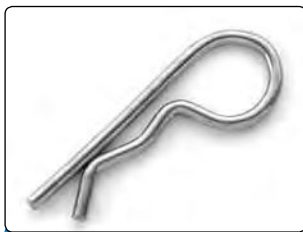

61000

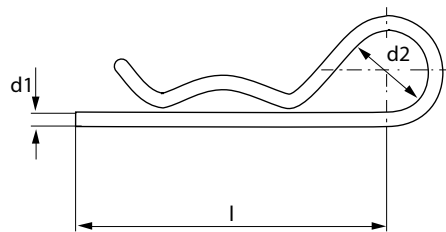

Name	Ident. no.	sur	body mat.	d1 mm	d2 mm	l mm	pack. unit	kg per 100 pcs	EAN-no. 4012053
61000-02	932696	vz	NO	2,0	10,0	50,0	50	0,3	09530 4
61000-03	932697	vz	NO	3,0	18,0	60,0	50	0,9	09531 1
61000-04	932698	vz	NO	4,0	20,0	75,0	50	1,6	09532 8
61000-05	932699	vz	NO	5,0	24,0	85,0	50	3,3	09533 5
61000-06	932700	vz	NO	6,0	30,0	105,0	50	6,2	09534 2
61000-07	932701	vz	NO	7,0	30,0	105,0	25	8,3	09535 9
61000-08	932702	vz	NO	8,0	28,0	110,0	25	10,5	09536 6

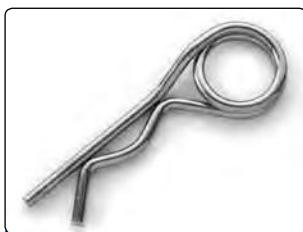

61500

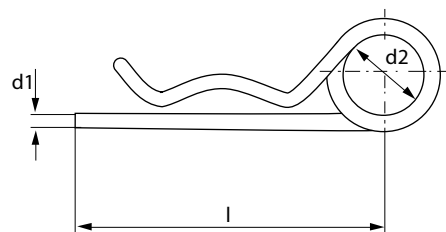

Name	Ident. no.	sur	body mat.	d1 mm	d2 mm	l mm	pack. unit	kg per 100 pcs	EAN-no. 4012053
61500-02	932703	vz	NO	2,0	16,0	50,0	50	0,4	09540 3
61500-03	932704	vz	NO	3,0	16,0	62,0	50	1,4	09541 0
61500-04	932705	vz	NO	4,0	23,0	78,0	25	3,0	09542 7
61500-05	932706	vz	NO	5,0	26,0	92,0	25	5,3	09543 4
61500-06	932707	vz	NO	6,0	30,0	120,0	25	9,6	09544 1
61500-07	932708	vz	NO	7,0	30,0	130,0	25	13,5	09545 8

# Press-clip DIN 3093



3093

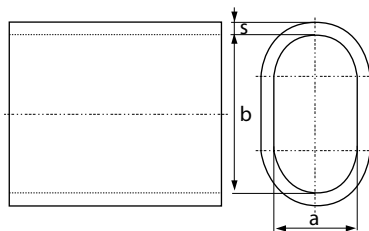

Name	Ident. no.	Mat	No.	a mm	b mm	l mm	s mm	pack. unit	kg per 100 pcs	EAN-no. 4012053
<b>DIN 3093</b>										
3093-01,0	933991	LM	1,0	1,2	2,4	5,0	0,65	100	0,01	13070 8
3093-01,5	933992	LM	1,5	1,7	3,4	6,0	0,75	100	0,02	13071 5
3093-02,0	933993	LM	2,0	2,4	4,8	7,0	0,85	100	0,03	13072 2
3093-02,5	933994	LM	2,5	2,7	5,4	9,0	1,05	100	0,05	13073 9
3093-03,0	933995	LM	3,0	3,3	6,6	11,0	1,25	100	0,08	13074 6
3093-03,5	933996	LM	3,5	3,8	7,6	13,0	1,50	100	0,13	13075 3
3093-04,0	933997	LM	4,0	4,4	8,8	14,0	1,70	100	0,18	13076 0
3093-04,5	933998	LM	4,5	4,9	9,8	16,0	1,90	100	0,26	13077 7
3093-05,0	933999	LM	5,0	5,5	11,0	18,0	2,10	100	0,36	13078 4
3093-06,0	934000	LM	6,0	6,6	13,2	21,0	2,50	100	0,59	13079 1
3093-06,5	934001	LM	6,5	7,2	14,4	23,0	2,70	50	0,75	13080 7
3093-07,0	934002	LM	7,0	7,8	15,6	25,0	2,90	50	0,95	13081 4
3093-08,0	934003	LM	8,0	8,8	17,6	28,0	3,30	50	1,37	13082 1
3093-09,0	934004	LM	9,0	9,9	19,8	32,0	3,70	25	1,98	13083 8
3093-10,0	934005	LM	10,0	10,9	21,8	35,0	4,10	25	2,64	13084 5
3093-12,0	934007	LM	12,0	13,2	26,4	42,0	4,90	10	4,58	13086 9
3093-14,0	934009	LM	14,0	15,3	30,6	49,0	5,80	10	7,50	13088 3
3093-16,0	934010	LM	16,0	17,5	35,0	56,0	6,70	5	11,10	13089 0
3093-18,0	934011	LM	18,0	19,6	39,2	63,0	7,60	5	15,90	13090 6
3093-20,0	934012	LM	20,0	21,7	43,4	70,0	8,40	5	21,70	13091 3
3093-22,0	934013	LM	22,0	24,3	48,6	77,0	9,20	5	29,20	13092 0
3093-24,0	934014	LM	24,0	26,4	52,8	84,0	10,00	5	37,60	13093 7



Rope & Chain

Safety

Tex

Tex Parts



227-S

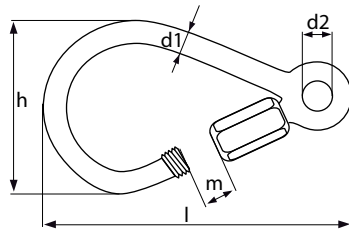

Name	Ident. no.	sur	body mat.	d1 mm	d2 mm	h mm	m mm	l mm	BS daN	pack. unit	kg per 100 pcs	EAN-no.
227-S-08	931206	sc	NO	8,0	11,0	60,0	14,0	106,5	1200	25	9,6	4012053 11549 1



2301-S-CE

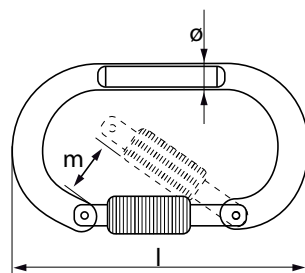

Name	Ident. no.	sur	body mat.	l mm	Ø mm	m mm	SL daN	pack. unit	kg per 100 pcs	EAN-no.
2301-S-CE	935033	vz	HS	104,0	10,0	18,0	2500	25	14,6	4012053 119611



2312-S-CE / 2316-S-CE

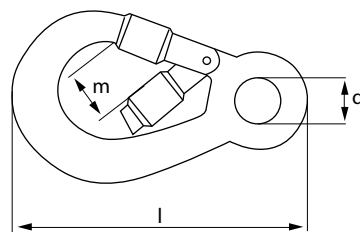

Name	Ident. no.	sur	body mat.	Rope-Ø mm	l mm	m mm	pack. unit	kg per 100 pcs	EAN-no.
2312-S-CE	931815	bl	LM	12,0	165,0	22,0	25	25,8	4012053 11900 0
2316-S-CE	931816	bl	LM	16,0	183,0	22,5	25	36,2	11901 7

An essential part of the fall absorber are the bolts.

We offer different bolts to fit the rope which is used.

To determine the bolt you need, it is essential to give us the particulars of your permission or ask for an advise of Henssgen.

Fall absorber with braking-bolts fitting the used rope, please consult the Henssgen team



229-S



229-TW2



2293-S-CE



5722-RH-60-CE



5721-RH-20-CE



5750-CE

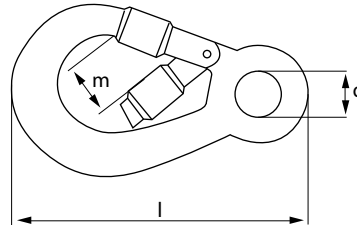

Name	Ident. no.	sur	body mat.	l mm	d mm	m mm	SWL daN	pack. unit	kg per 100 pcs	EAN-no. 4012053
229-S	931646	bl	LM	135,0	22,0	20,0	1600	50	16,0	11920 8

229-TW2	930050	bl	LM	165,0	23,0	21,0	1600	10	22,3	11923 9
---------	--------	----	----	-------	------	------	------	----	------	---------

Name	Ident. no.	sur	body mat.	l mm	d mm	m mm	SL daN	pack. unit	kg per 100 pcs	EAN-no. 4012053
2293-S-CE	930021	vz	SS	155,0	23,5	21,0	2500	10	34,2	11940 6

5722-RH-60-CE	917946	bl	LM	240,0	22,0	62,0	2000	5	45,7	11950 5
---------------	--------	----	----	-------	------	------	------	---	------	---------

5721-RH-20-CE	940100	bl	LM/NS	137,6	20,0	22,0	2000	10	12,0	09377 5
---------------	--------	----	-------	-------	------	------	------	----	------	---------

5750-CE	931392	ge	NO	129,0	22,0	18,0	2000	50	24,0	12731 9
---------	--------	----	----	-------	------	------	------	----	------	---------



2980-S-CE



2985-TW3-CE



2286-TW3-CE

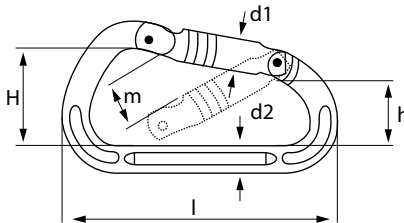

Name	Ident. no.	sur	body mat.	l mm	d1 mm	d2 mm	m mm	h mm	H mm	SL daN	pack. unit	kg per 100 pcs	EAN-no. 4012053
2980-S-CE	930039	el	LM	121,0	18,0	13,0	23,0	28,0	51,0	2000	10	8,9	11987 1
2985-TW3-CE	930040	el	LM	122,0	18,0	13,0	22,0	22,0	51,0	2000	10	9,6	11988 8
2286-TW3-CE	930041	el	LM	125,0	18,0	15,0	24,0	23,0	62,0	2000	10	10,3	11989 5

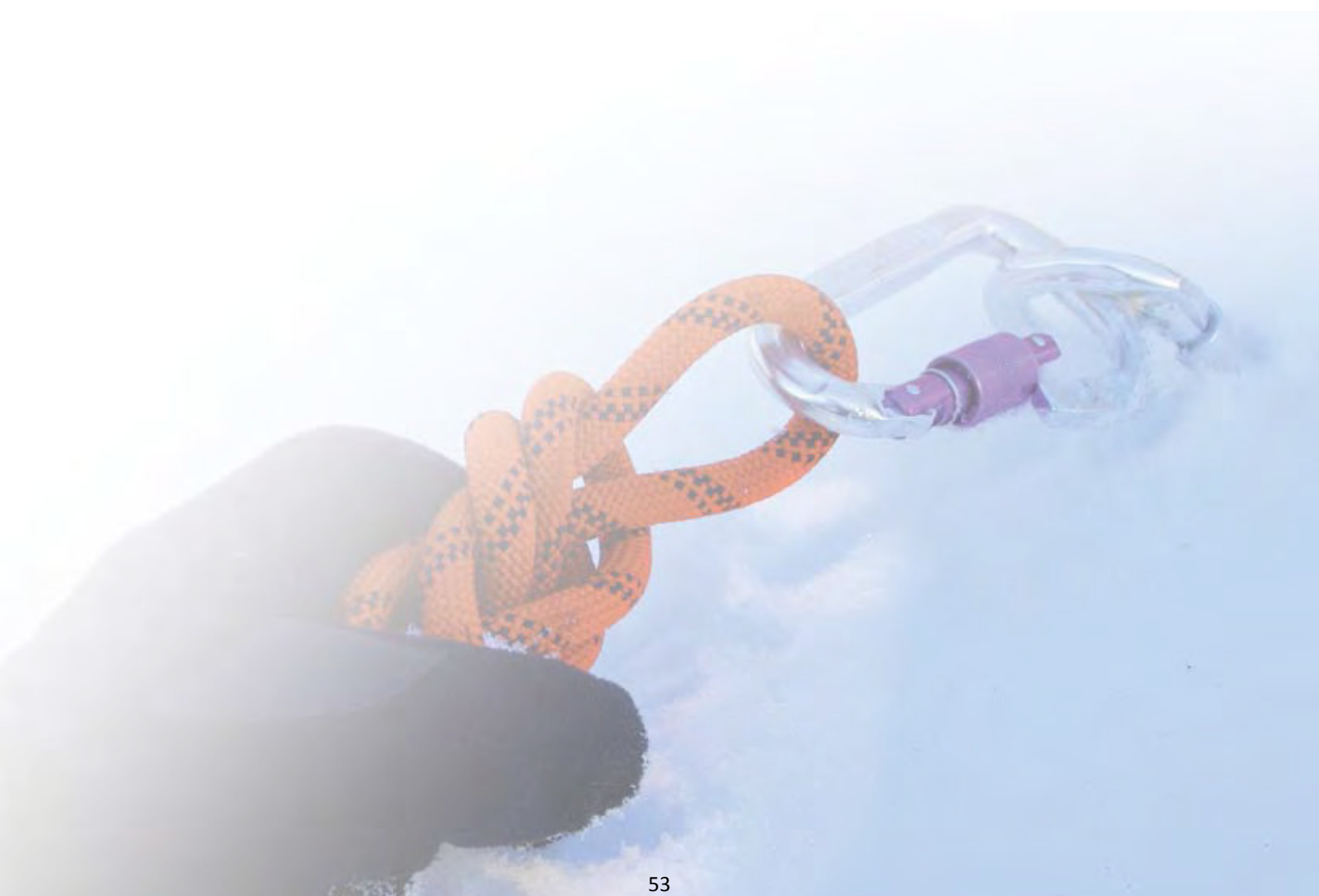



2301-S-B-CE



2303-TW3-CE

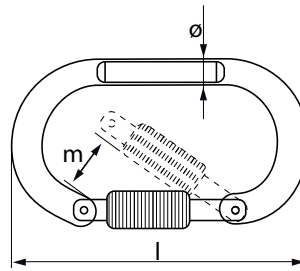

Name	Ident. no.	sur	body mat.	l mm	m mm	Ø mm	SL daN	pack. unit	kg per 100 pcs	EAN-no. 4012053
2301-S-B-CE	935039	fz	LM	110,0	18,0	11,0	2000	10	7,4	09122 1
2303-TW3-CE	935031	el	LM	110,0	16,0	11,0	2000	10	8,3	11972 7

S = screw-Lock = first unscrew then open  
 TW2 = twist-Lock = first twist 90° then open  
 TW3 = triLock = first push, then twist 90°, then open



5740-RH-21-CE



2292-TW2-CE



5750-B-CE



5722-RH-60-B-CE

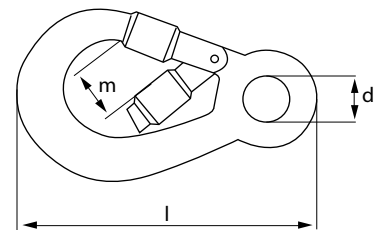

Name	Ident. no.	sur	body mat.	l mm	d mm	m mm	SL daN	pack. unit	kg per 100 pcs	EAN-no. 4012053	
5740-RH-21-CE	940101	el	LM	140,0	21,0	22,0	2000	10	12,5	09406 2	
2292-TW2-CE	930024	el	LM	177,0	22,0	24,0	2000	10	21,3	11943 7	
5750-B-CE	931394	fs	LM	140,0	21,0	18,0	2000	10	13,5	12732 6	
5722-RH-60-CE	917947	fs	LM	240,0	22,0	54	62,0	2000	10	48,3	11952 9

# Safety Snap Hook / Swivel



2960-S-CE / 2970-S-CE

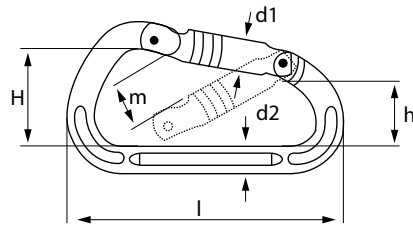

Name	Ident. no.	sur	body mat.	l mm	d1 mm	d2 mm	h mm	H mm	m mm	SL daN	pack. unit	kg per 100 pcs	EAN-no.
2960-S-CE	930037	el	LM	110,0	12,0	12,0	28,0	36,0	22,0	2200	10	7,2	11984 0
2970-S-CE	930038	el	LM	114,0	12,0	12,0	28,0	46,0	22,0	2200	10	8,8	11985 7



9500



INOX

1851-I

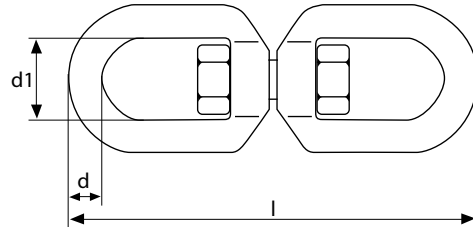

Name	Ident. no.	sur	body mat.	l mm	d1 mm	d mm	SL daN	pack. unit	kg per 100 pcs	EAN-no.
9500	930023	ge	HS	64,5	45,0	9,0	2200	50	16,9	4012053 12000 6
1851-I	930822	bl	NS	114,0	21,0	3,0	1600	25	12,3	11951 2

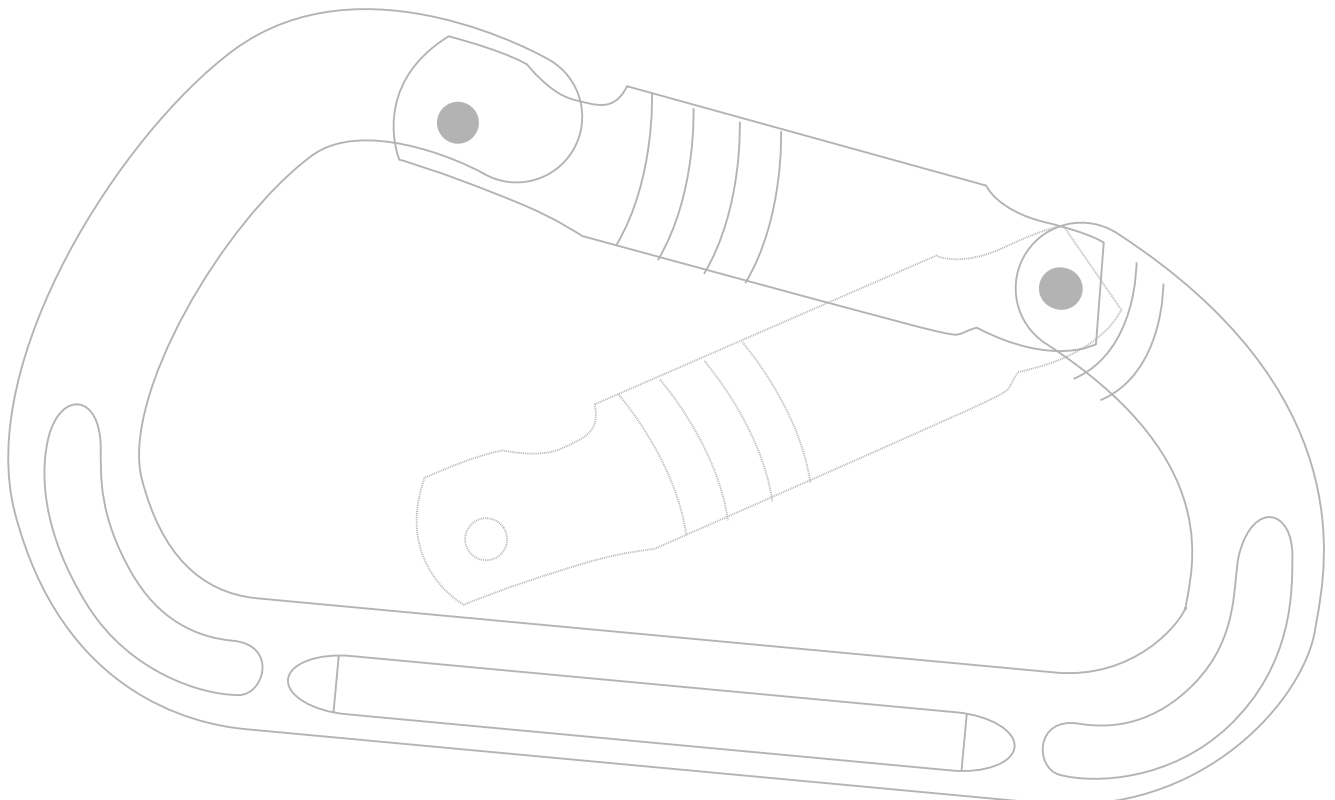





255-LM-CE



255-ST



INOX

255-I



INOX

256-I



256-45-7



302-44



INOX

302-I-44-CE



302-86-CE



305-86-CE

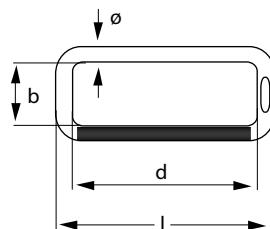
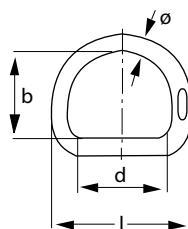

Name	Ident. no.	sur	body mat.	l mm	d mm	b mm	ø mm	SL daN	pack. unit	kg per 100 pcs	EAN-no. 4012053
255-LM-45-12-CE	931810	vz	LM	79,0	45,0	50,0	12,0	1500	100	7,1	12010 5
255-ST-25-4,5	914362	vz	NO	35,0	25,0	21,0	4,5	-	250	1,2	12011 2
255-I AISI 316	926620	bl	NS	62,0	47,0	40,0	7,0	1100	25	5,2	12012 9
256-I AISI 304	931361	bl	NS	60,0	45,0	39,0	4,0	1500	50	3,8	12120 1
256-45-7	914365	vz	NO	60,0	45,0	45,0	7,0	1500	100	6,0	12013 6
302-44	931887	bl	LM	59,0	44,0	28,0	7,0	1000	250	1,8	12030 3
302-I-44-CE AISI 304	926621	bl	NS	56,5	44,5	14,5	6,0	1000	25	2,9	12031 0
302-86-CE	931812	bl	LM	105,0	86,0	28,0	9,0	800	100	4,6	12032 7
305-86-CE	931813	bl	LM	104,0	86,0	35,0	9,0	800	100	4,6	12050 1



2990-CE



200-86-CE



7472-F

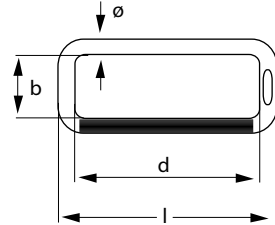
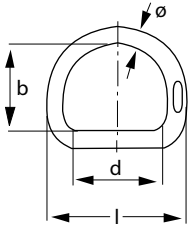

Name	Ident. no.	sur	body mat.	l mm	d mm	b mm	Ø mm	SL daN	pack. unit	kg per 100 pcs	EAN-no. 4012053
2990-CE	931814	bl	LM	110,0	86,0	10,0	11,0	1600	100	10,1	12060 0
200-86-CE	931808	bl	LM	105,0	86,0	28,0	9,0	800	100	5,8	12070 9
7472-F-12-CE	931649	bl	LM	68,0	20,0	29,5	9,5	1500	200	4,1	12090 7
7472-F-16-CE	931650	bl	LM	95,0	32,5	33,0	10,0	1500	100	5,7	12091 4
7472-G	931821	bl	LM	100,0	75,0	20,0	10,0	1200	100	6,0	12092 1



5764 / 5765



5770-I-64-62-6

Name	Ident. no.	sur	body mat.	l mm	d mm	b mm	Ø mm	SL daN	BS daN	pack. unit	kg per 100 pcs	EAN-no. 4012053
5764	950036	vz	HS	64,0	45,0	9,5	9,0	3000	5000	100	8,2	12110 2
5765	932318	vz	HS	64,0	45,0	9,5	7,0	1500	3000	50	7,2	12111 9
5770-I-64-62-6	935052	bl	A2	64,0	46,0	47,0	-	1500	3000	300	6,4	09143 6



843

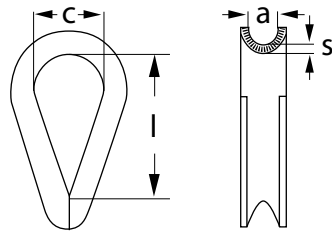

Name	Ident. no.	sur	body mat.	Rope ø mm	a mm	c mm	l mm	s mm	pack. unit	kg per 100 pcs	EAN-no.
843-12	913452	bl	LM	12,0	12,0	21,0	40,0	1,5	50	1,1	12080 8
843-16	900305	bl	LM	24,0	16,0	24,0	40,0	1,5	20	1,3	12081 5



6245 female

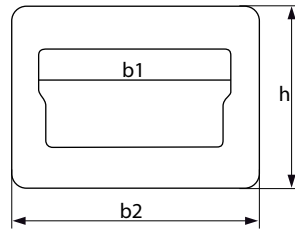

6245 male

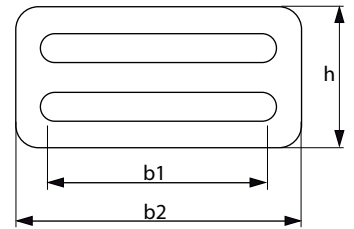

Name	Ident. no.	sur	body mat.	b1 mm	b2 mm	h mm	thickness mm	SL daN	pack. unit	kg per 100 pcs	EAN-no.
6245-04-F	940013	vz	NO	48,0	62,0	45,5	4,0	900	400	4,9	4012053 09389 8
6245-04-M	940014	vz	NO	45,0	58,0	29,0	4,0	900	400	3,8	09390 4
6245-03M	940007	vz	NO	45,0	58,0	29,0	3,0	900	400	2,7	09395 9

# Adjustable Buckle / Backgate



6424



6425

Name	Ident. no.	sur	body mat.	b1 mm	b2 mm	h mm	thickness mm	SL daN	pack. unit	kg per 100 pcs	EAN-no.
6424-45	940011	vz	NO	46,0	64,0	55,0	4,0	1500	200	10,4	4012053 09382 9
6425-45	940010	ge	NO	46,0	64,0	55,0	4,0	1500	200	10,4	09379 9



45

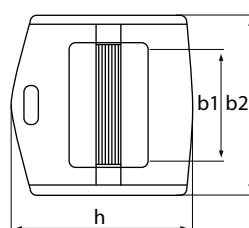
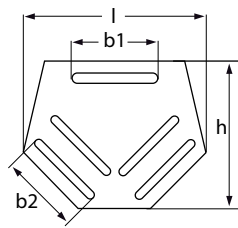

Name	Ident. no.	sur	body mat.	b1 mm	b2 mm	h mm	l mm	pack. unit	kg per 100 pcs	EAN-no.
45-35	940020	fb	KS	55,0	45,0	85,0	103,0	50	2,2	4012053 9380 5



45-16

Name	Ident. no.	sur	body mat.	For belt width mm	For belt thickness mm	pack. unit	kg per 100 pcs	EAN-no.
45-16	940021	fb	KS	45,0	1,5	100	0,2	4012053 9381 2

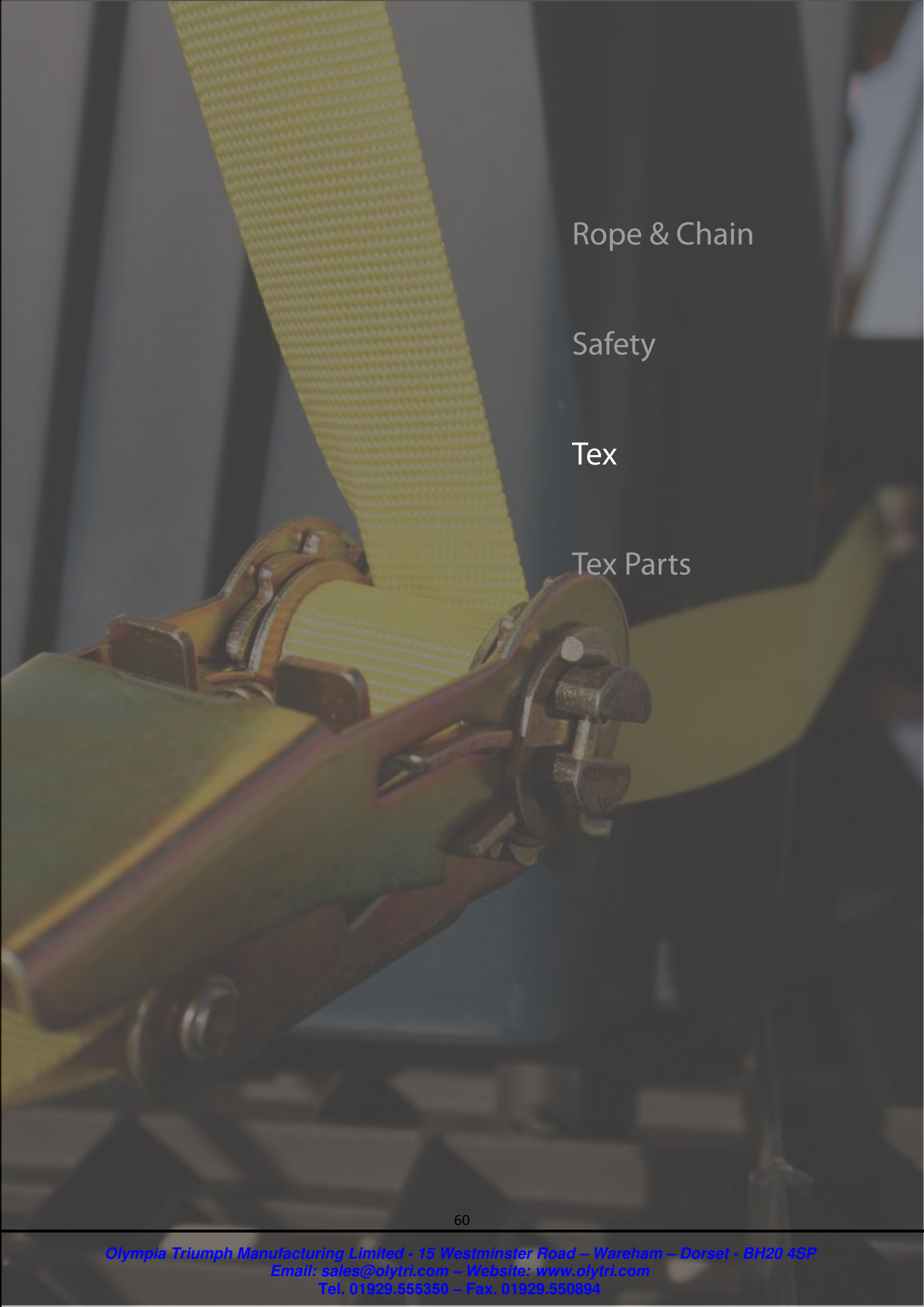
A close-up photograph of a yellow lifting strap with metal hardware. The strap is made of a woven fabric and is attached to a metal shackle. The hardware includes a large metal eye, a smaller metal eye, and a metal plate. The background is a blurred industrial setting.

Rope & Chain

Safety

Tex

Tex Parts



ACB 2518



ACB 5030

Name	Ident. no.	color	webbing mm	min. workable length mm	max. workable length mm	BS daN	SWL daN	pack. unit	kg per 100 pcs	EAN-no. 4012053
AutoCargoBelt ACB 2518	959970	■ black	25	400	1850	500	250	30	61,5	13320 4
AutoCargoBelt ACB 5030	959971	■ black	50	400	3000	1000	500	12	132,5	13321 1



## Belt system



5t

Name	System no.	webbing mm	webbing thickness mm	system length m	color	LC 12195-2 daN	BS* daN	weight kg
5t 8m	959993	50	3,3	8	orange	2500	5000	2,8
5t 9m	959992	50	3,3	9	orange	2500	5000	3,0

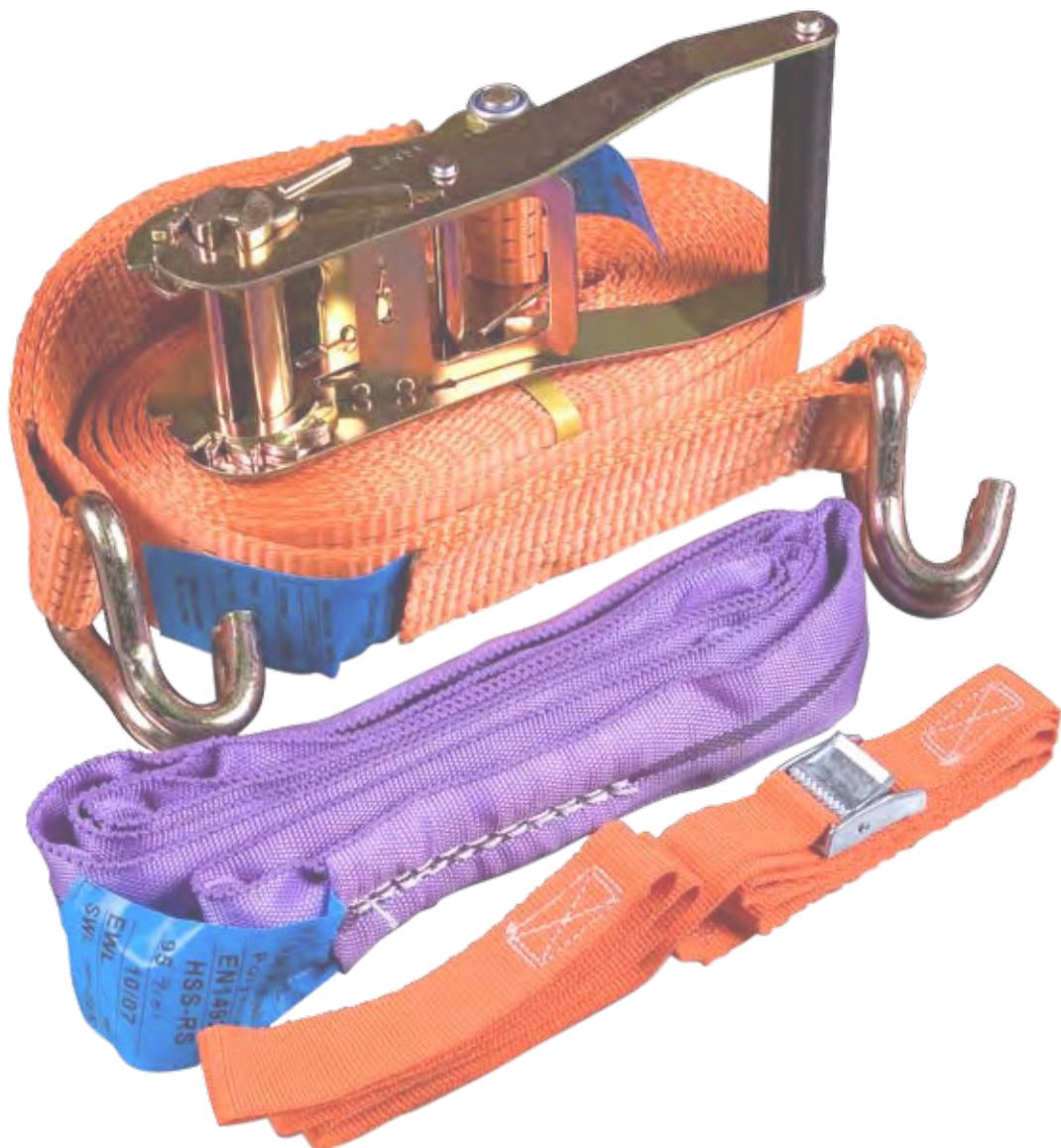

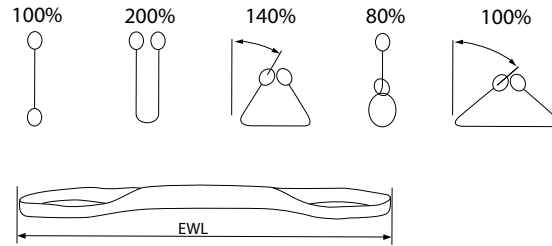

Name	Ident. no.	SWL daN	EWL* m	bandwidth mm	color	EAN-no. 4012053
HB - 1000 - 1,00	959200	1000	1,00	30,00	violet	13580 2
HB - 1000 - 2,00	959201	1000	2,00	30,00	violet	13581 9
HB - 1000 - 3,00	959202	1000	3,00	30,00	violet	13582 6
HB - 1000 - 4,00	959203	1000	4,00	30,00	violet	13583 5
HB - 1000 - 5,00	959204	1000	5,00	30,00	violet	13584 0
HB - 1000 - 6,00	959205	1000	6,00	30,00	violet	13585 7
HB - 2000 - 2,00	959206	2000	2,00	60,00	green	13586 4
HB - 2000 - 3,00	959207	2000	3,00	60,00	green	13587 1
HB - 2000 - 4,00	959208	2000	4,00	60,00	green	13588 8
HB - 2000 - 5,00	959209	2000	5,00	60,00	green	13589 5
HB - 2000 - 6,00	959210	2000	6,00	60,00	green	13590 1
HB - 2000 - 8,00	959211	2000	8,00	60,00	green	13591 8
HB - 3000 - 2,00	959212	3000	2,00	90,00	yellow	13582 5
HB - 3000 - 3,00	959213	3000	3,00	90,00	yellow	13593 2
HB - 3000 - 4,00	959214	3000	4,00	90,00	yellow	13594 9
HB - 3000 - 5,00	959215	3000	5,00	90,00	yellow	13595 6
HB - 3000 - 6,00	959216	3000	6,00	90,00	yellow	13596 3
HB - 3000 - 8,00	959217	3000	8,00	90,00	yellow	13597 0
HB - 4000 - 2,00	959218	4000	2,00	120,00	grey	13598 7
HB - 4000 - 3,00	959219	4000	3,00	120,00	grey	13599 4
HB - 4000 - 4,00	959220	4000	4,00	120,00	grey	13600 7
HB - 4000 - 5,00	959221	4000	5,00	120,00	grey	13601 4
HB - 5000 - 4,00	959222	5000	4,00	150,00	red	13602 1
HB - 5000 - 5,00	959223	5000	5,00	150,00	red	13603 8
HB - 5000 - 6,00	959224	5000	6,00	150,00	red	13604 5
HB - 5000 - 8,00	959225	5000	8,00	150,00	red	13605 2
HB - 6000 - 4,00	959226	6000	4,00	180,00	brown	13606 9
HB - 6000 - 5,00	959227	6000	5,00	180,00	brown	13607 6
HB - 6000 - 6,00	959228	6000	6,00	180,00	brown	13608 3
HB - 6000 - 8,00	959229	6000	8,00	180,00	brown	13609 0

\* EWL = effectiv working length

Safety factor 7:1



# Round sling EN 1492-2

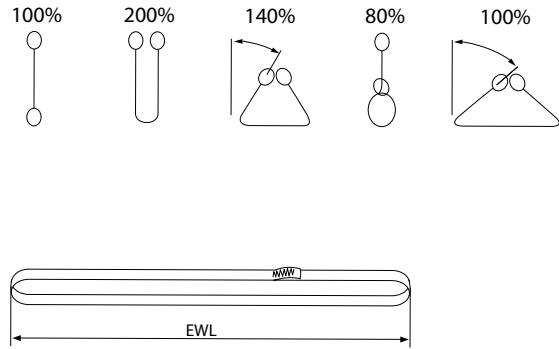

Name	Ident. no.	SWL daN	EWL* m	bandwidth mm	color	EAN-no. 4012053
RS - 1000 - 0,50	959100	1000	0,50	50	violet	13510 9
RS - 1000 - 1,00	959101	1000	1,00	50	violet	13511 6
RS - 1000 - 1,50	959102	1000	1,50	50	violet	13512 3
RS - 1000 - 2,00	959103	1000	2,00	50	violet	13513 0
RS - 1000 - 3,00	959104	1000	3,00	50	violet	13514 7
RS - 1000 - 4,00	959105	1000	4,00	50	violet	13515 4
RS - 2000 - 0,50	959106	2000	0,50	50	green	13516 1
RS - 2000 - 1,00	959107	2000	1,00	50	green	13517 8
RS - 2000 - 1,50	959108	2000	1,50	50	green	13518 5
RS - 2000 - 2,00	959109	2000	2,00	50	green	13519 2
RS - 2000 - 2,50	959110	2000	2,50	50	green	13520 8
RS - 2000 - 3,00	959111	2000	3,00	50	green	13521 5
RS - 2000 - 4,00	959112	2000	4,00	50	green	13522 2
RS - 3000 - 1,00	959113	3000	1,00	55	yellow	13523 9
RS - 3000 - 1,50	959114	3000	1,50	55	yellow	13524 6
RS - 3000 - 2,00	959115	3000	2,00	55	yellow	13525 3
RS - 3000 - 3,00	959116	3000	3,00	55	yellow	13526 0
RS - 3000 - 4,00	959117	3000	4,00	55	yellow	13527 7
RS - 4000 - 2,00	959118	4000	2,00	60	grey	13528 4
RS - 4000 - 3,00	959119	4000	3,00	60	grey	13529 1
RS - 4000 - 4,00	959120	4000	4,00	60	grey	13530 7
RS - 5000 - 2,00	959121	5000	2,00	70	red	13531 4
RS - 5000 - 3,00	959122	5000	3,00	70	red	13532 1
RS - 5000 - 4,00	959123	5000	4,00	70	red	13533 8
RS - 6000 - 2,00	959124	6000	2,00	83	brown	13534 5
RS - 6000 - 3,00	959125	6000	3,00	83	brown	13535 2
RS - 6000 - 4,00	959126	6000	4,00	83	brown	13536 9
RS - 8000 - 3,00	959127	8000	3,00	85	blue	13537 6
RS - 8000 - 4,00	959128	8000	4,00	85	blue	13538 3
RS - 10000 - 3,00	959129	10000	3,00	112	orange	13539 0
RS - 10000 - 4,00	959130	10000	4,00	112	orange	13540 6

\* EWL = effectiv working lenght

Safety factor 7:1



Name	Ident. no.	color	webbing mm	l m	BS daN	clamping Lock	pack. unit	kg per 100 pcs	EAN-no.
B25/250L4,5	935059	■ black	25	4,5	250,0	5702-25	1	16,1	4012053 13270 2



# Round Belt



Name	Ident. no.	color	webbing mm	l m	BS daN	clamping Lock	pack. unit	kg per 100 pcs	EAN-no.
B25/0250L1,95	129115	orange	25	1,95	250,0	5702-25	1	7,8	4012053 09402 4



Name	Ident. no.	color	webbing mm	l m	BS daN	clamping Lock	hook	pack. unit	kg per 100 pcs	EAN-no.
B25/0450L1,0	129118	red	25	1,0	450,0	5701-25	5725-25	1	11,7	4012053 09403 1
B25/0450L2,0	129119	red	25	2,0	450,0	5701-25	5725-25	1	13,9	4012053 09405 5

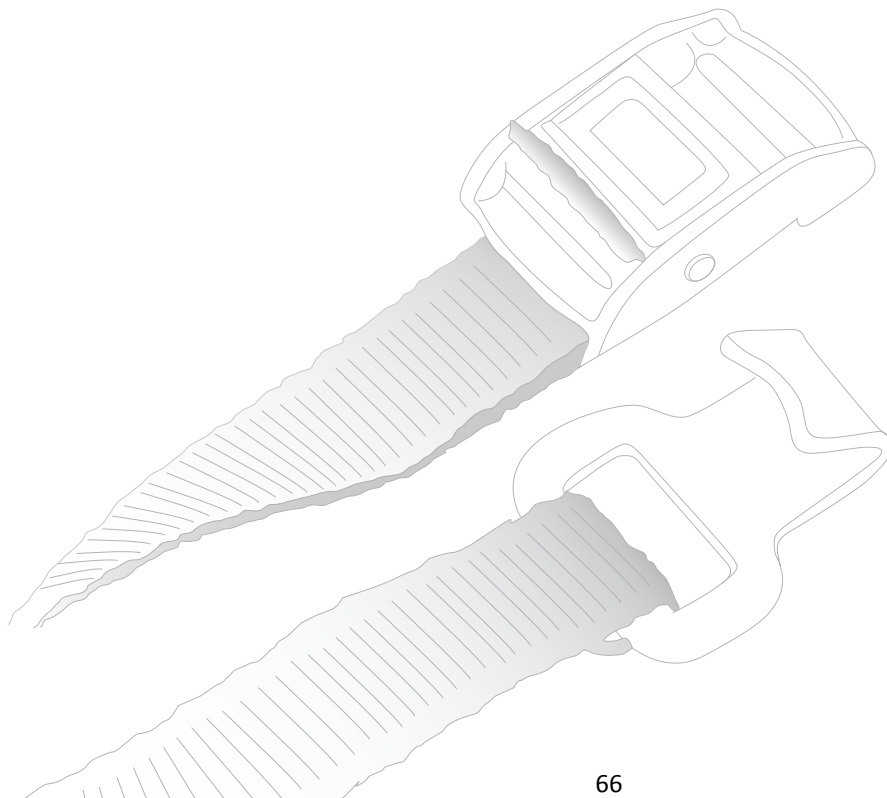



Rope & Chain

Safety

Tex

Tex Parts

# Fitting for cargo restraint system



5703-18



5700-25

Belt 1,5 - 2,2 mm



5701-25

Belt 1,2 - 1,7 mm



5702-25

Belt 1,8 - 2,2 mm



5704-25



5706-25



5710-25

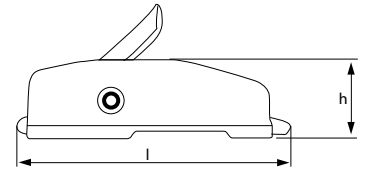

The breaking strength indicated refers to the frame of the cam buckle. To determine the breaking strength of the complete system, this must be performed after final assembly.

Name	Ident. no.	sur	mat.	webbing mm	h mm	l mm	BS daN	SWL daN	pack. unit	kg per 100 pcs	EAN-no. 4012053
5703-18	932758	vz	ZD	18	10,0	34,5	250	125	800	2,1	12671 8
5700-25	929946	ge	NO	25	22,0	65,0	750	375	250	11,4	12670 1
5701-25	931933	bl	ZD	25	15,0	52,0	450	225	500	4,8	12680 0
5702-25	930383	bl	ZD	25	12,0	44,0	250	125	500	3,6	12690 9
5704-25	929949	bl	ZD	25	17,0	54,0	500	250	300	7,0	12930 6
5706-25	950024	bl	ZD	25	13,0	67,0	500	250	200	6,5	12672 5
5710-25	930390	bl	A4	25	20,0	66,0	-	-	250	3,8	12660 2





234-B-25



234-25



234-V2-25



234-IB-25



Inox

234-IV2-25

Name	Ident. no.	sur	mat.	webbing mm	h mm	l mm	BS daN	SWL daN	pack. unit	kg per 100 pcs	EAN-no. 4012053
234-B-25	929935	sc	NO	25	35,0	115,0	800	400	100	20,7	12700 5
234-25	931619	ge	NO	25	42,0	133,0	1000	500	50	35,0	12710 4
234-V2-25	929934	ge	HS	25	43,0	132,0	1500	750	60	39,7	12720 3
234-IB-25	932757	bl	NS	25	40,0	109,0	500	250	100	21,7	12702 9
234-IV2-25	932756	bl	NS	25	40,0	133,0	1500	750	60	34,1	12721 0

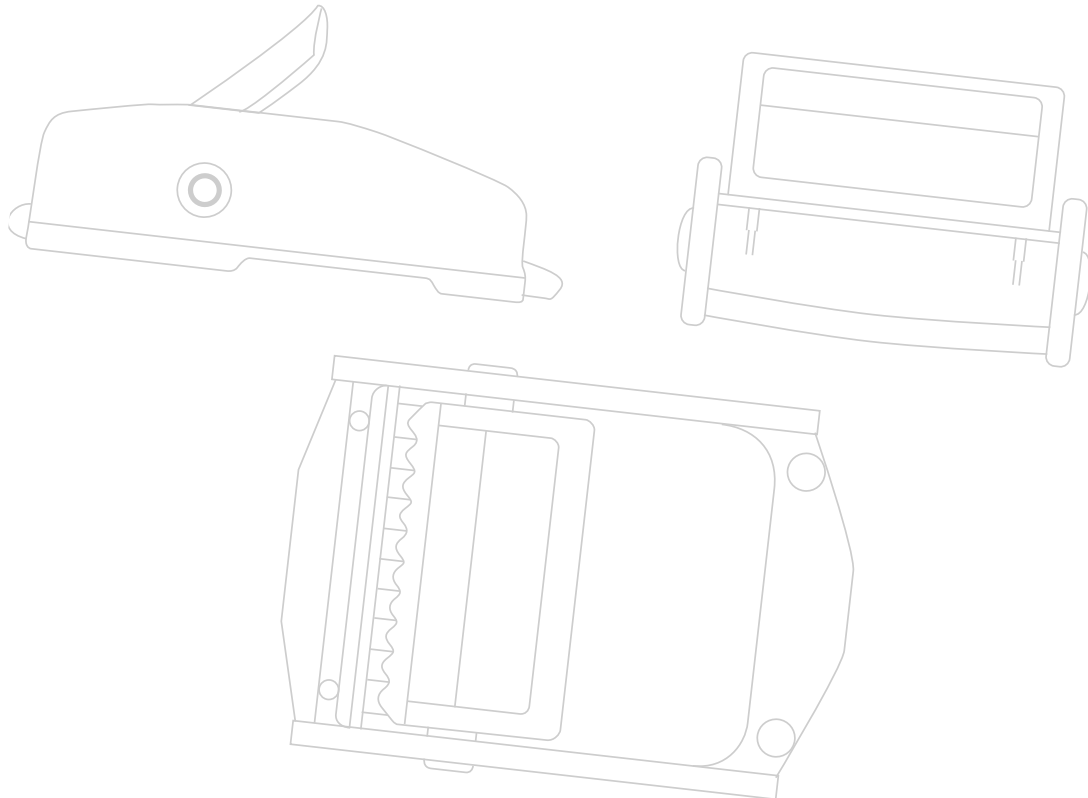



5745-VC-25



5720-R-25



5726-25



5726-S-25



2311-TR-30



5723-25



5725-25

Name	Ident. no.	sur	mat.	webbing mm	h Ø mm	l mm	BS daN	SWL daN	pack. unit	kg per 100 pcs	EAN-no. 4012053
5745-VC-25	929950	pv	NO	25	7,0	105,0	500	250	200	9,5	12730 2
5720-R-25	930077	ge	HS	25	8,0	79,0	1500	750	250	10,5	12740 1
5726-25	930061	ge	HS	25	6,0	34,0	1000	500	200	3,3	12750 0
5726-S-25	930055	ge	HS	25	7,0	54,0	1000	500	200	6,4	12751 7
2311-TR-30	931019	vz	NO	30	-	120,0	1800	900	20	20,9	12760 9
5723-25	933796	ge	HS	25	4,0	83,0	1000	500	100	8,4	12741 8
5725-25	930060	vz	HS	25	3,0	53,0	1500	750	250	4,2	12961 0



5705-36



5712-WH-36



5712-36



5734-36



5736-36



5736-1-36



5783-36

Name	Ident. no.	sur	mat.	webbing mm	h Ø mm	l mm	BS daN	SWL daN	pack. unit	kg per 100 pcs	EAN-no. 4012053
5705-36	931364	bl	ZD	36	22,0	60,0	600	300	200	12,3	12780 7
5712-WH-36	930047	ge	HS	36	42,0	155,0	3000	1500	40	59,0	12770 8
5712-36	931618	ge	HS	36	49,0	160,0	3000	1500	40	55,9	12780 7
5734-36	950023	ge	HS	36	9,0	52,0	2200	1100	1	10,6	12891 0
5736-36	933022	ge	HS	36	11,0	90,0	2200	1100	1	17,2	12790 6
5736-1-36	933020	ge	HS	36	9,0	73,0	3000	1500	200	13,2	12791 3
5783-36	905963	vz	NO	36	18,0	144,5	2200	1100	10	40,6	12800 2



## Fitting for cargo restraint system



5711-50

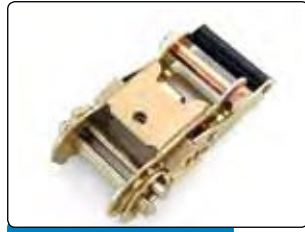

235-3-50



235-1-50



235-LP-50

Name	Ident. no.	sur	mat.	webbing mm	h mm	l mm	BS daN	SWL daN	pack. unit	kg per 100 pcs	EAN-no.
5711-50	919840	po	HS	50	23,0	137,0	2000	1000	50	30,4	12950 4
235-3-50	931617	ge	HS	50	55,0	170,0	3000	1500	20	96,5	12810 1
235-1-50	932251	ge	HS	50	61,0	230,0	5000	2500	20	114,5	12821 7
235-LP-50	931787	ge	HS	50	68,0	335,0	5000	2500	12	156,1	09404 8

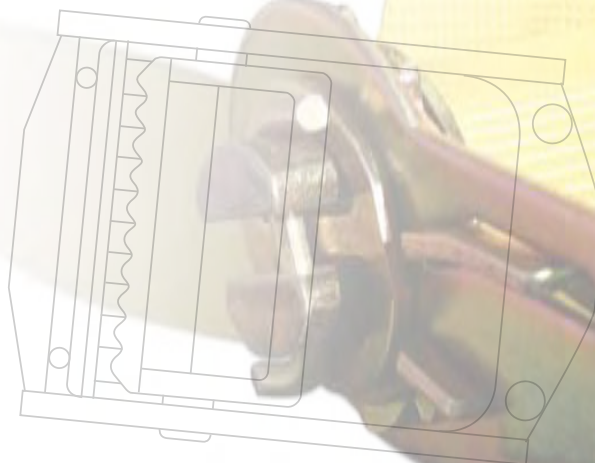
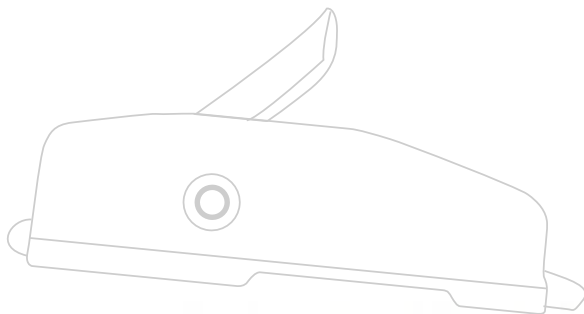



232-50



233-50



5730-50



5751-50

Name	Ident. no.	sur	mat.	webbing mm	h Ø mm	l mm	BS daN	SWL daN	pack. unit	kg per 100 pcs	EAN-no.
232-50	929932	ge	HS	50	5,0	150,0	5000	2500	25	25,7	4012053 12840 0
233-50	929933	ge	HS	50	6,0	155,0	5000	2500	25	31,4	12850 7
5730-50	925864	ge	HS	50	15,0	107,0	5000	2500	10	63,9	12880 4
5751-50	932657	ge	HS	50	30,0	72,0	1000	500	200	9,1	12940 5



5729-50



5731-M-50



5731-K-50



5743-50



5744-50

Name	Ident. no.	sur	mat.	webbing mm	Ø mm	l mm	BS daN	SWL daN	pack. unit	kg per 100 pcs	EAN-no.
5729-50	930056	ge	HS	50	12,0	75,0	5000	2500	50	16,5	4012053 12860 6
5731-M-50	934985	ge	HS	50	11,0	90,0	5000	2500	1	23,7	12870 5
5731-K-50	930049	ge	HS	50	11,0	74,0	5000	2500	1	21,3	12871 2
5743-50	933672	ge	HS	50	11,5	140,0	2000	1000	1	27,4	12971 9
5744-50	933817	ge	HS	50	14,5	130	5000	2500	25	39,9	12972 6



5733-50



5733-R-50



5746-50



5746-S-50



5732-50

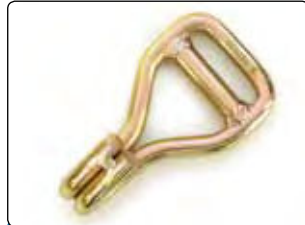

5731-50-NS

Name	Ident. no.	sur	mat.	webbing mm	Ø mm	l mm	BS daN	SWL daN	pack. unit	kg per 100 pcs	EAN-no.
5733-50	933818	ge	HS	50	6,0	66,0	5000	2500	25	13,5	4012053 12902 3
5733-R-50	930046	ge	HS	50	12,0	90,0	5000	2500	50	17,8	12900 9
5746-50	929951	ge	HS	50	12,5	160,0	5000	2500	50	47,3	12910 8
5746-S-50	929952	ge	HS	50	12,5	160,0	5000	2500	50	49,1	12920 7
5732-50	918319	ge	HS	50	4,2	110,0	2700	1350	100	15,2	12890 3
5731-50-NS	934987	ge	HS	50	12,0	138,0	5000	2500	1	46,2	12872 9



5784-45

Name	Ident. no.	sur	mat.	webbing mm	Ø mm	l mm	BS daN	SWL daN	pack. unit	kg per 100 pcs	EAN-no.
5784-45	905088	ge	NO	45	5,0	63,0	1600	800	1	4,5	4012053 12801 9

